

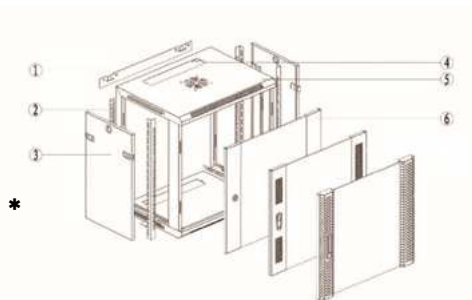

## RACKS MURALES DE 19" 450MM FONDO R6 19 450 / R9 19 450

REFERENCIA		R6 19 450	R9 19 450
Código		396001	396002
Apertura de la puerta	°	180	
Paneles laterales		2	
Entradas de cable		2 (Superior e inferior)	
Carga estática	Kg	60	
Vidrio templado	mm	5	
Índice de protección		IP20	
Dimensiones (An. X Fo. X AL.)	mm	600 x 450 x 370 - 6U	600 x 450 x 500 - 9U

\*Bandeja no incluida



\*

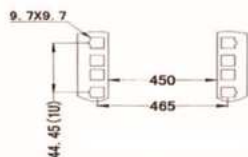
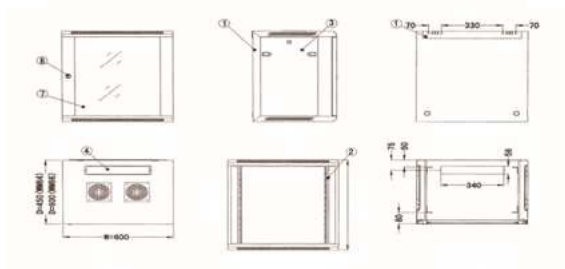

\*

1. [ES] Panel trasero  
[EN] Back board

---

2. [ES] Perfil de montaje (L)  
[EN] Mounting profile (L-shaped)

---

3. [ES] Panel lateral  
[EN] Lateral side panel

---

4. [ES] Pletina para entrada de cable  
[EN] Cable entry plate

---

5. [ES] Cuerpo  
[EN] Main body

---

6. [ES] Puerta con apertura 180°  
[EN] 180° opening door

---

7. [ES] Vidrio templado  
[EN] Tempered glass

---

8. [ES] Cerradura  
[EN] Lock