

PRODUCT DATASHEET

LB FLEX 1200 P 73W 840 W

LOW BAY FLEX 1200 | Low-bay luminaires with attractive linear design, up to 155 lm/W



Areas of application

- Replacement for luminaires with mercury vapor or metal halide lamps
- Warehouses
- Logistics halls
- Industrial and storage facilities
- Discounters, supermarkets

Product benefits

- Economical thanks to high luminous efficacy up to 155 lm/W
- Easy and quick installation thanks to toolless connector box with 5- and 7-pole terminals
- Modern and robust design
- 5 years guarantee

Product features

- Different luminous flux and beam angle for mounting heights of ~ 4 m to ~10 m in 4000 K
- Through-wiring cable already installed
- Long Lifetime (L80/B10): up to 100,000 h
- High color consistency: ≤ 3 SDCM



TECHNICAL DATA

Electrical data

Nominal wattage	73 W
Nominal voltage	220...240 V
Mains frequency	50...60 Hz
Nominal current	320 mA
Inrush current	42.91 A
Inrush current time T_{h50}	1.9 μ s
Max. no. of lum. on circuit break. B16 A	17
Max. no. of lum. on circuit break. C10 A	13
Max. no. of lum. on circuit break. C16 A	22
Power factor λ	≥ 0.90
Total harmonic distortion	$\leq 20 \%$
Protection class	I
Operating mode	ELECTRONIC CONTROL GEAR (ECG)

Photometrical data

Luminous flux	11315 lm
Luminous efficacy	155 lm/W
Color temperature	4000 K
Light color (designation)	Cool White
Color rendering index Ra	≥ 80
Standard deviation of color matching	< 3 sdcn
Low flicker	Yes
Photobiological safety group acc. to EN62778	RG1
Photobiological safety group acc. to EN62471	RG1
Beam angle	90 °



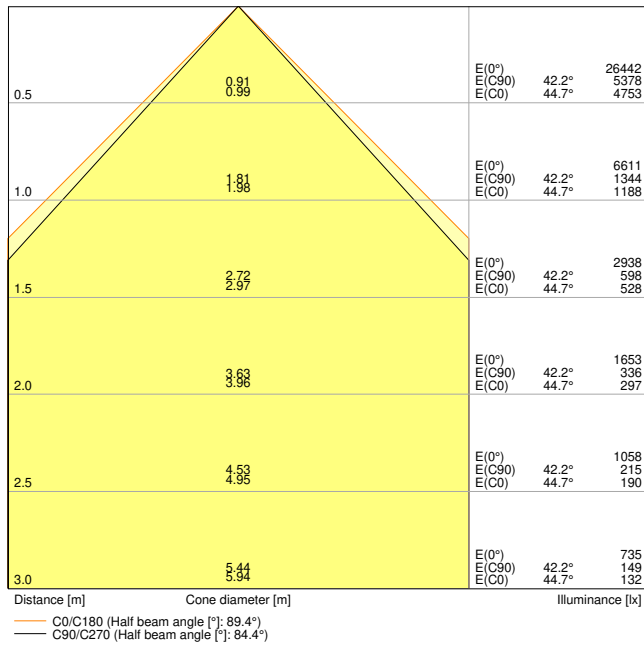

LDC typ cone

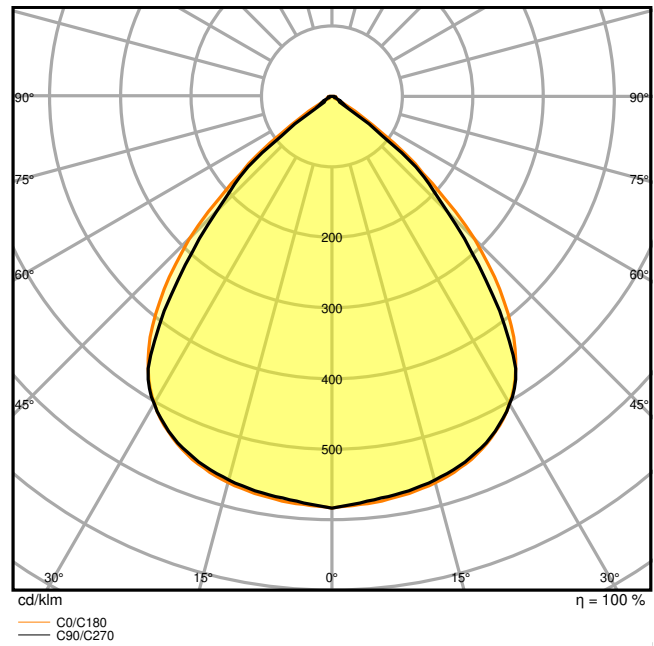

LDC typ polar

Dimensions & Weight

Length	1236 mm
Width	115.00 mm
Height	65.00 mm
Product weight	3400.00 g

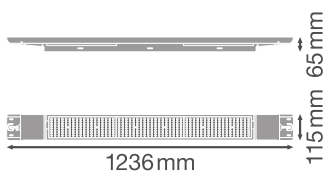

Materials & Colors

Product color	White
Housing color	White
Body material	Steel
Glow Wire Test according to IEC 60695-2-12	650 °C
Mercury content	0.0 mg

Application & Mounting

Ambient temperature range	-25...+50 °C
Temperature range at storage	-40...+80 °C
Type of connection	Screwless terminal
Type of protection	IP23
Protection class IK (shock resistance)	IK08
Dimmable	No
Mounting type	Surface/Suspended
Mounting location	Ceiling
Application environment	Indoor
LED module replaceable	Not replaceable
With light source	Yes

Lifespan

Lifespan L70/B50 at 25 °C	100000 h
Lifespan L80/B10 at 25 °C	100000 h
Lifespan L90/B10 at 25 °C	83000 h
Number of switching cycles	50000

Control gear

Output current	310 mA
----------------	--------

Certificates & Standards









Standards	CE / CB / ENEC / TÜV SÜD / EAC / UKCA
Luminaire with limited surface temperature, "D sign"	No
Ball shot safe	No

EQUIPMENT / ACCESSORIES

- Suspension kit available as separate accessory



DOWNLOAD DATA

DOWNLOAD DATA	
	User instruction
	Addon Technical Information
	Tender documents
	Declarations of conformity
	IES file (IES)
	LDT file (Eulumdat)
	R3D file (Relux 3D Model)
	M3D file (3D Model)
	UGR file (UGR table)

LOGISTICAL DATA

Product code	Packaging unit (Pieces/Unit)	Dimensions (length x width x height)	Gross weight	Volume
4058075676114	Shipping box 3	1,264 mm x 250 mm x 156 mm	13901.00 g	49.30 dm ³

The mentioned product code describes the smallest quantity unit which can be ordered. One shipping unit can contain one or more single products. When placing an order, for the quantity please enter single or multiples of a shipping unit.

ADDITIONAL CATALOG INFORMATION



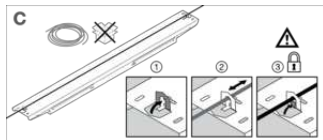
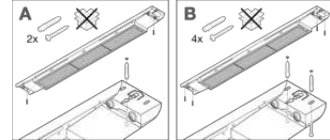
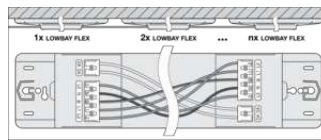
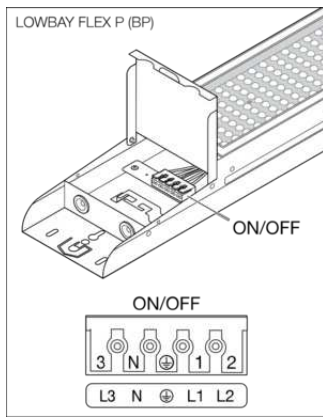

References / Links

- For Guarantee see www.ledvance.com/guarantee

DISCLAIMER

Subject to change without notice. Errors and omission excepted. Always make sure to use the most recent release.

