

# SACE Tmax XT

Sganciatore differenziale RC Inst - RC Sel.  
 RC Inst - RC Sel Residual-current release.  
 Fehlerstromauslöser RC Inst - RC Sel.  
 Déclencheur différentiel RC Inst - RC Sel.  
 Relè diferencial RC Inst - RC Sel.

XT1-XT3

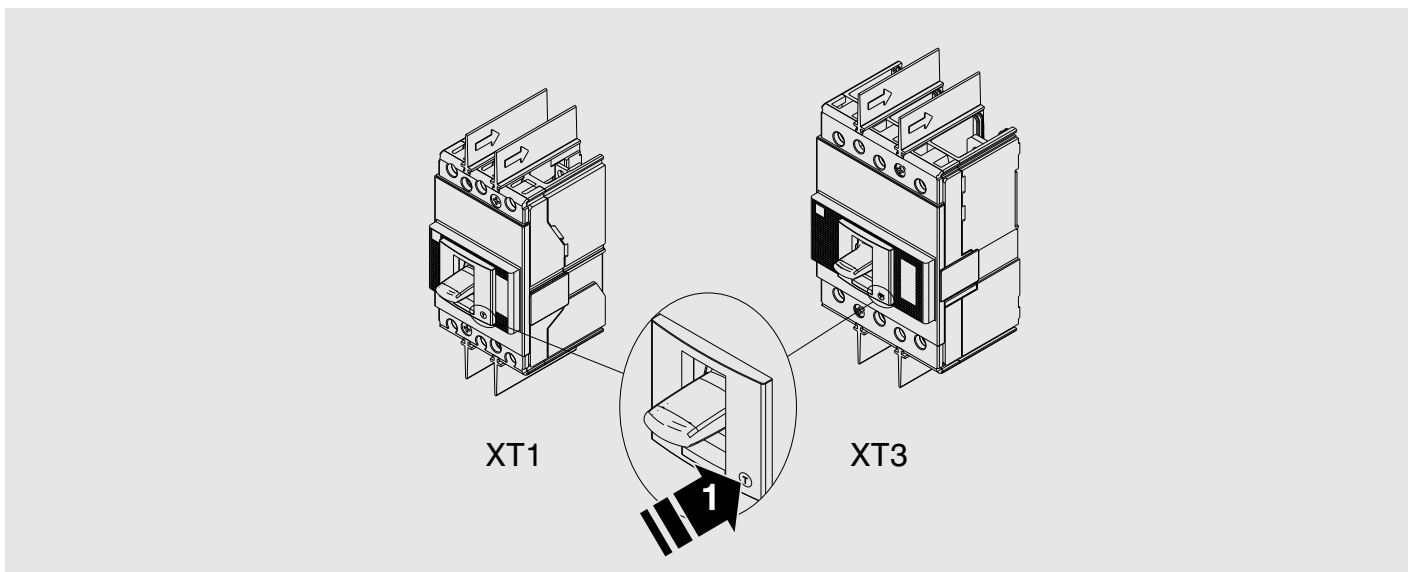

XT1 III	6	-	1	1	2	2	1	-	-	-
XT1 IV	8	-	1	1	2	2	-	1	-	-
XT3 III	-	6	1	1	2	2	-	-	1	-
XT3 IV	-	8	1	1	2	2	-	-	-	1

XT1 III

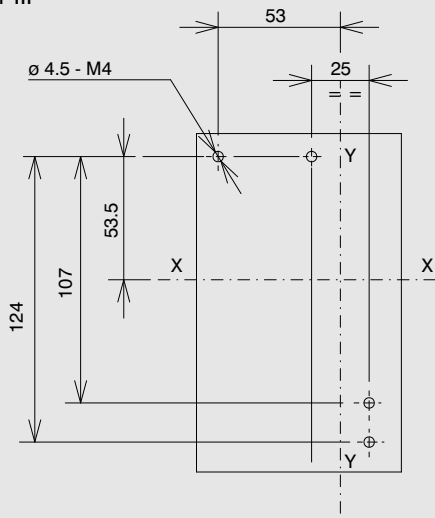

XT1 IV

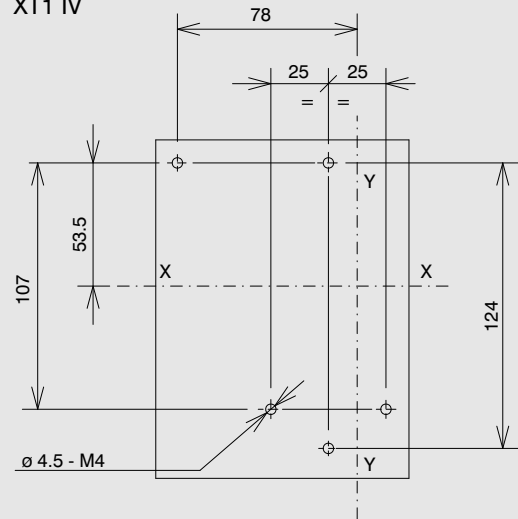

XT3 III

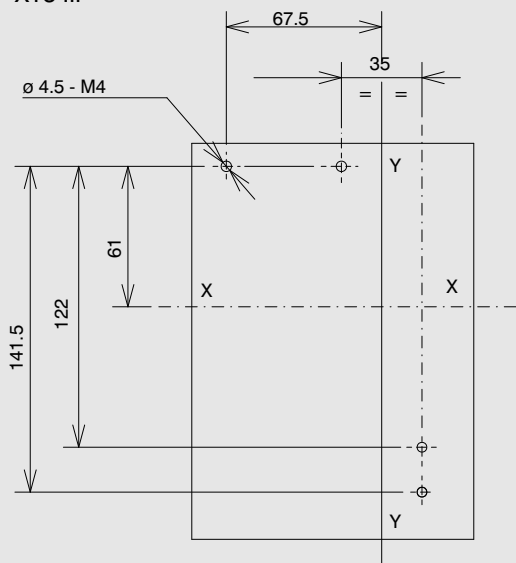

XT3 IV

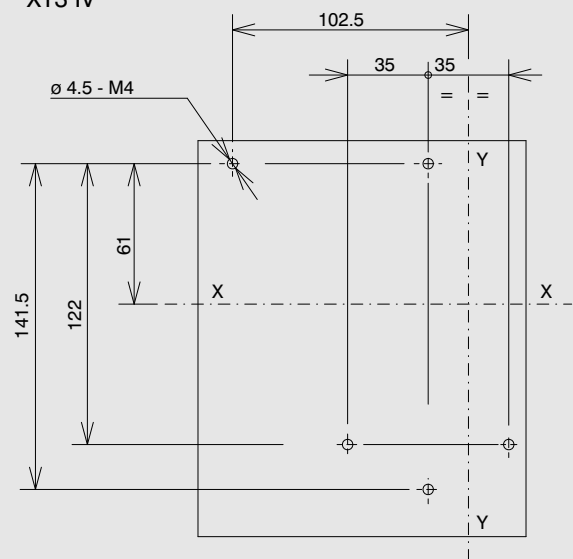

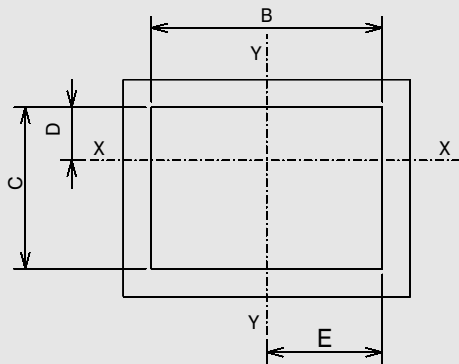
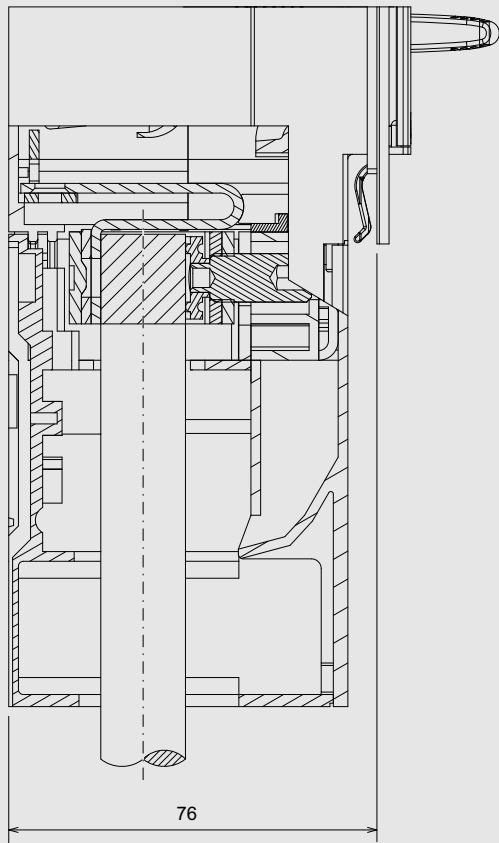

XT1 III	A	B	C	D	E
CON MOSTRINA WITH FLANGE	74	113,5	55	21	40,5
SENZA MOSTRINA WITHOUT FLANGE	71	105,5	47	17	36,5

XT1 IV	A	B	C	D	E
CON MOSTRINA WITH FLANGE	74	138,5	55	21	40,5
SENZA MOSTRINA WITHOUT FLANGE	71	130,5	47	17	36,5

XT3 III	A	B	C	D	E
CON MOSTRINA WITH FLANGE	74	142,5	55	17,5	55
SENZA MOSTRINA WITHOUT FLANGE	71	134,5	47	13,5	51

XT3 IV	A	B	C	D	E
CON MOSTRINA WITH FLANGE	74	177,5	55	17,5	55
SENZA MOSTRINA WITHOUT FLANGE	71	169,5	47	13,5	51

3

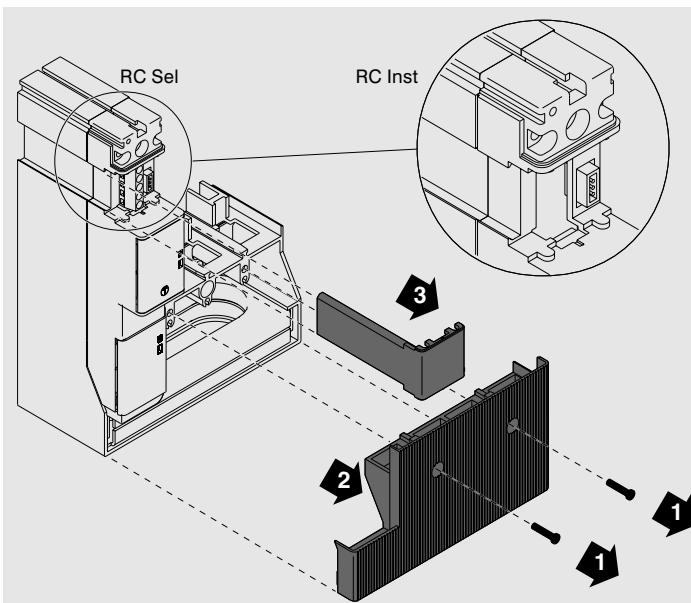

4

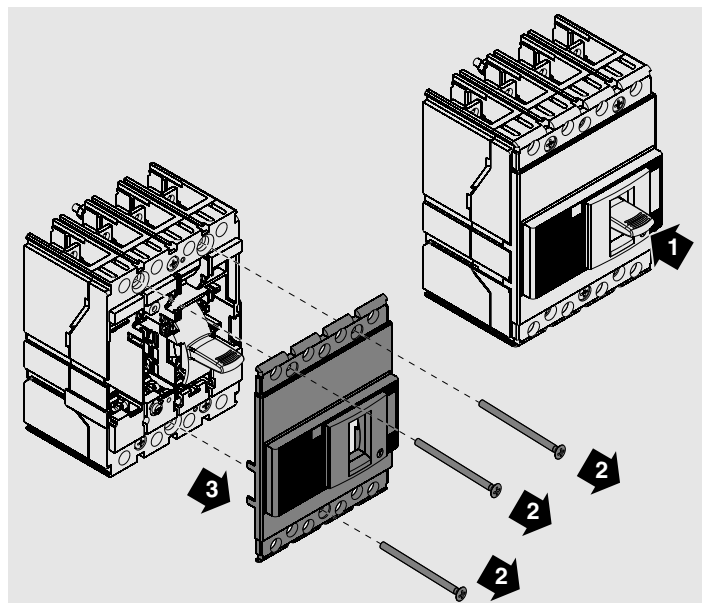

5

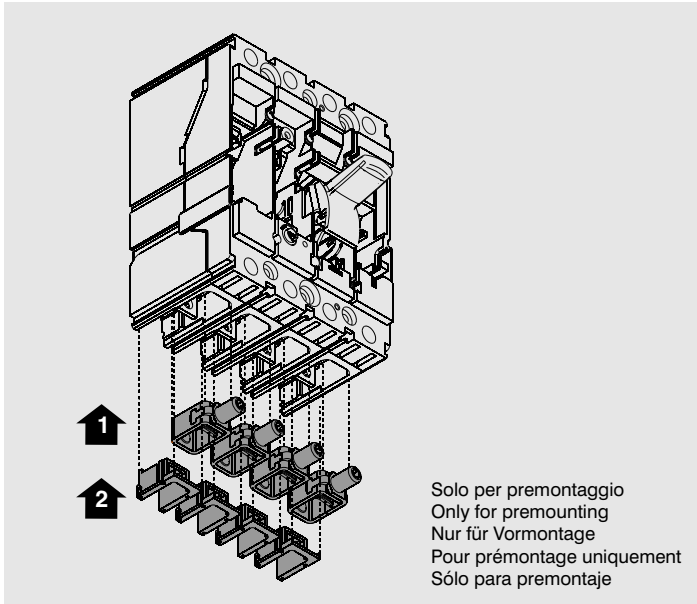

6

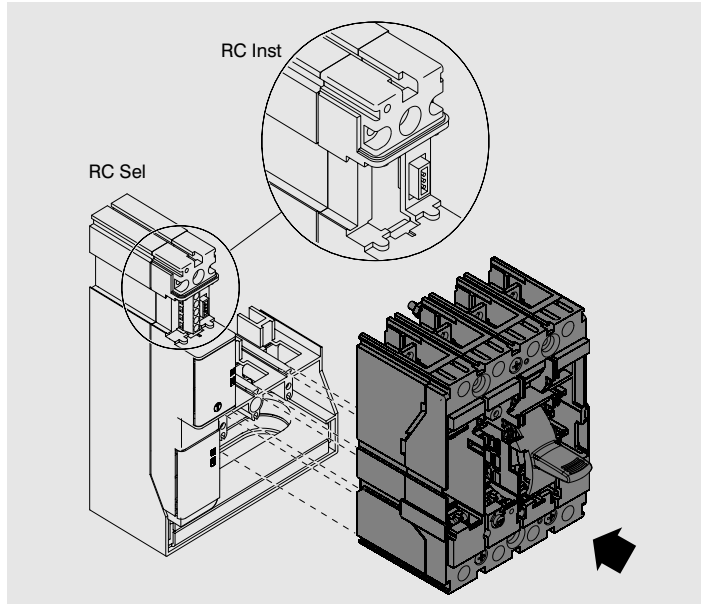

7

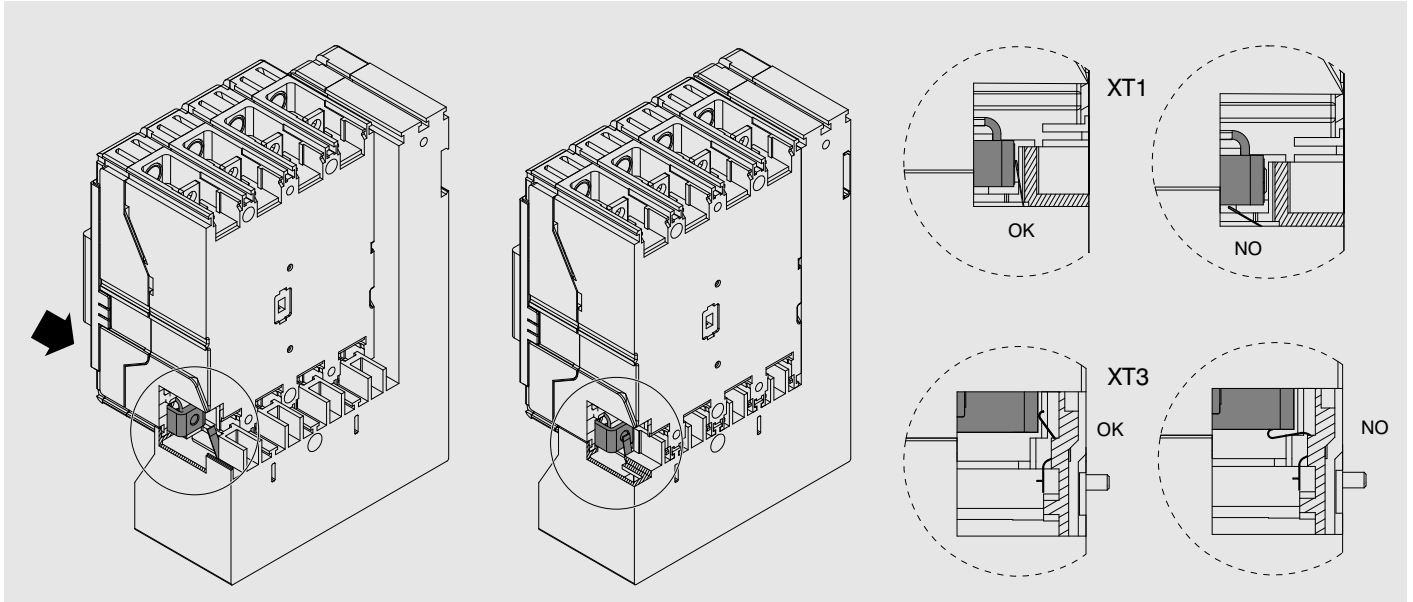

8

RC Sel

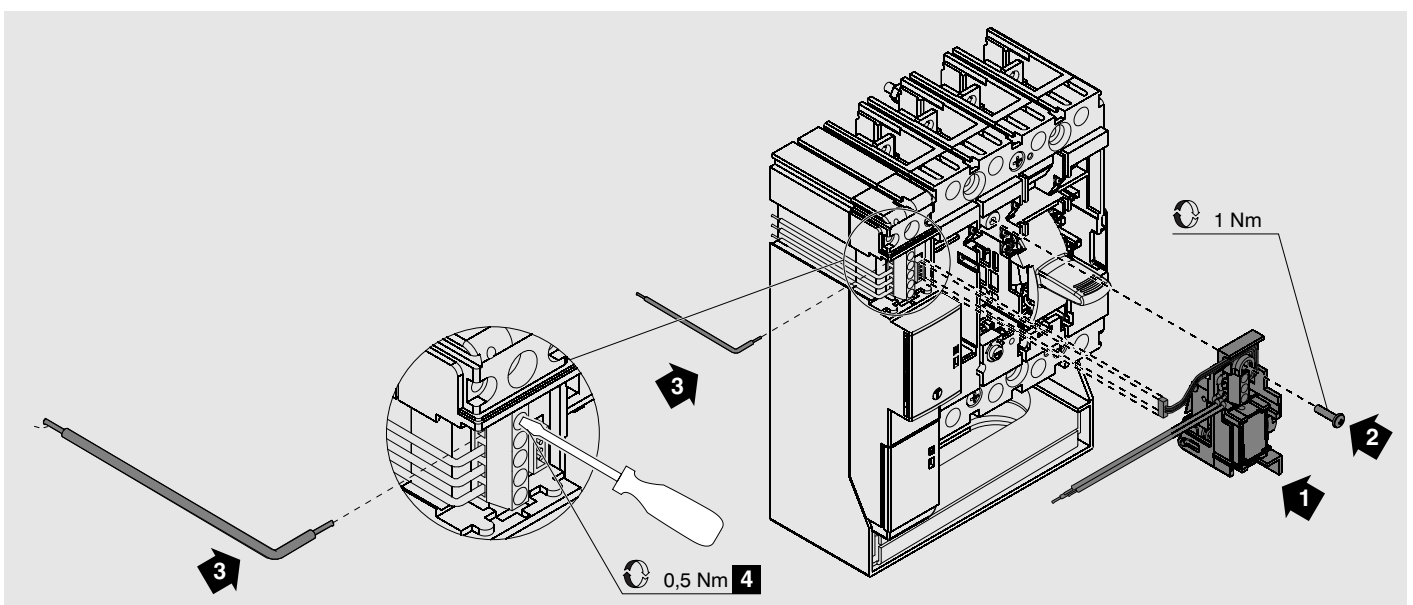

9

RC Sel

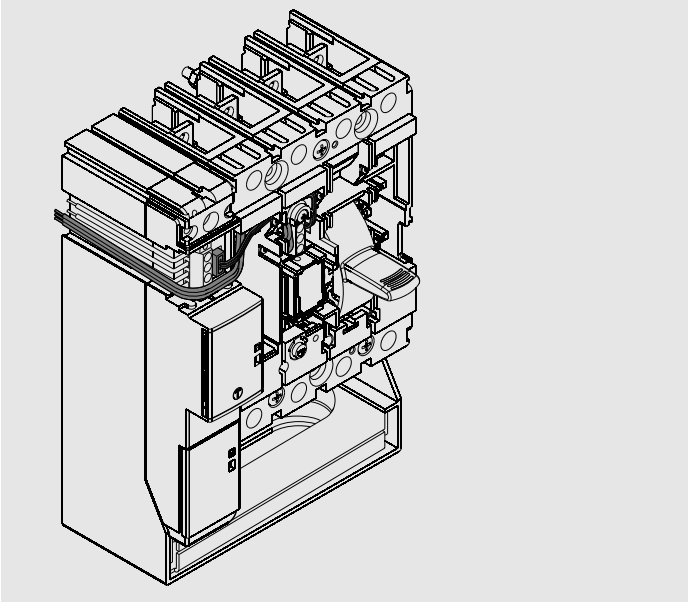

10

RC Inst

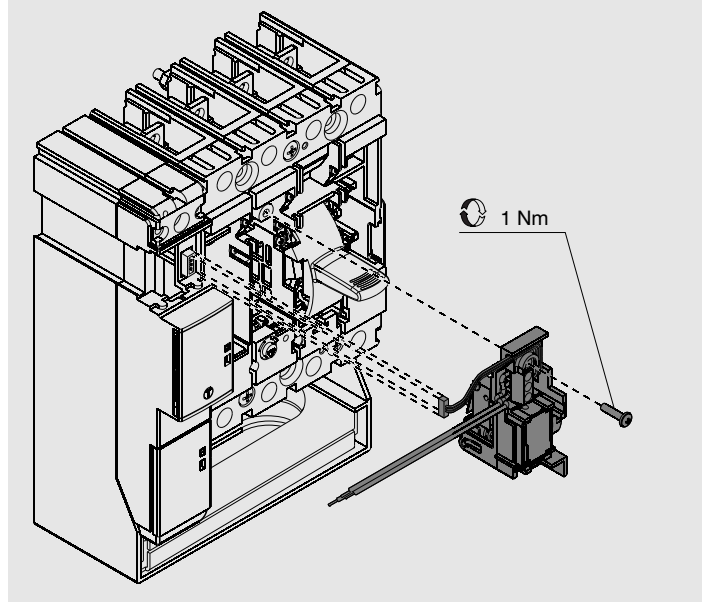

11

RC Inst

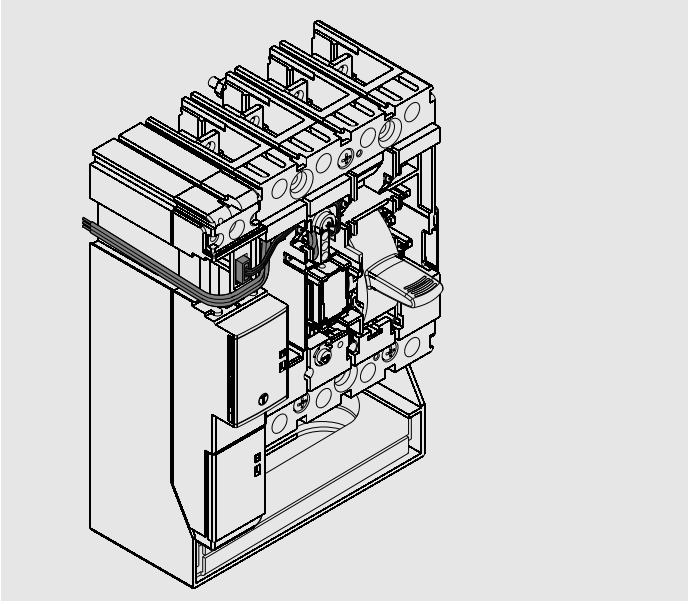

12

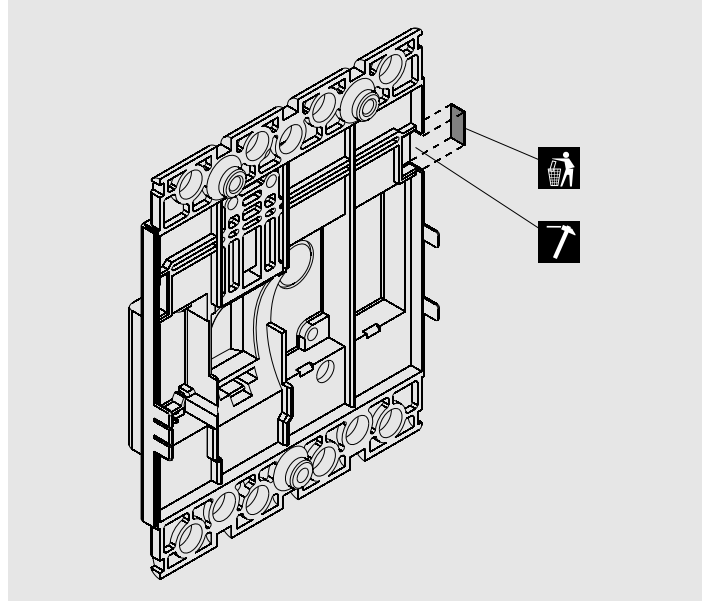

13

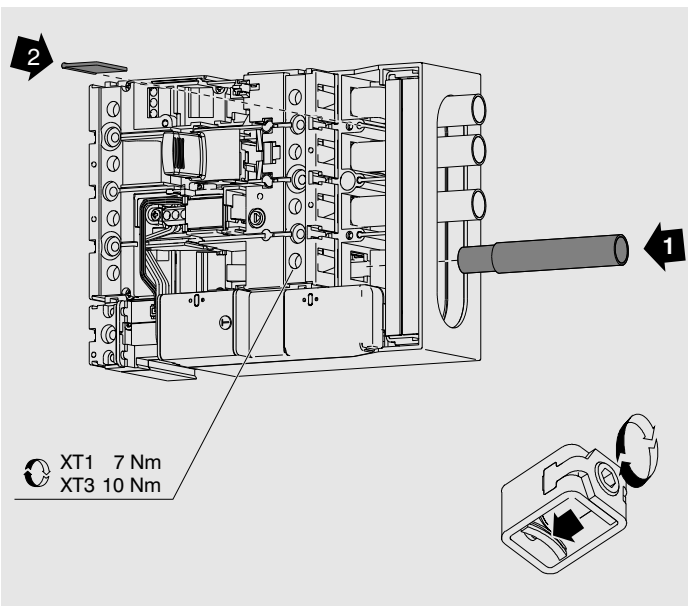

14

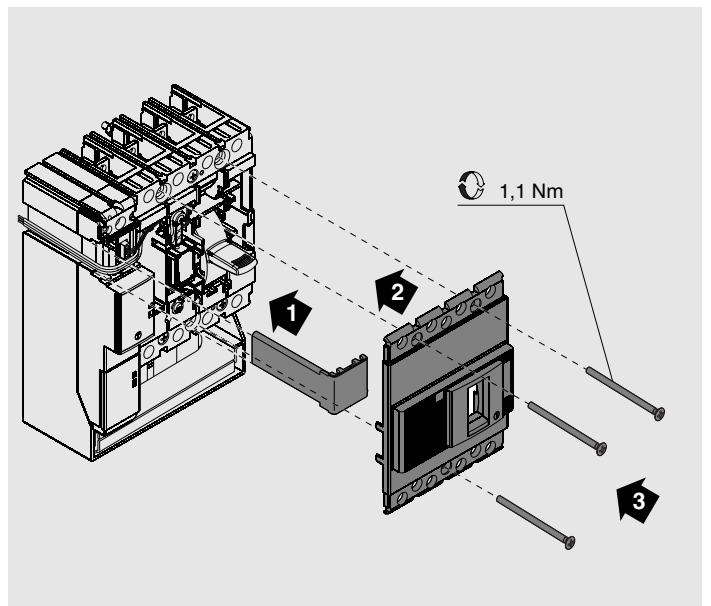

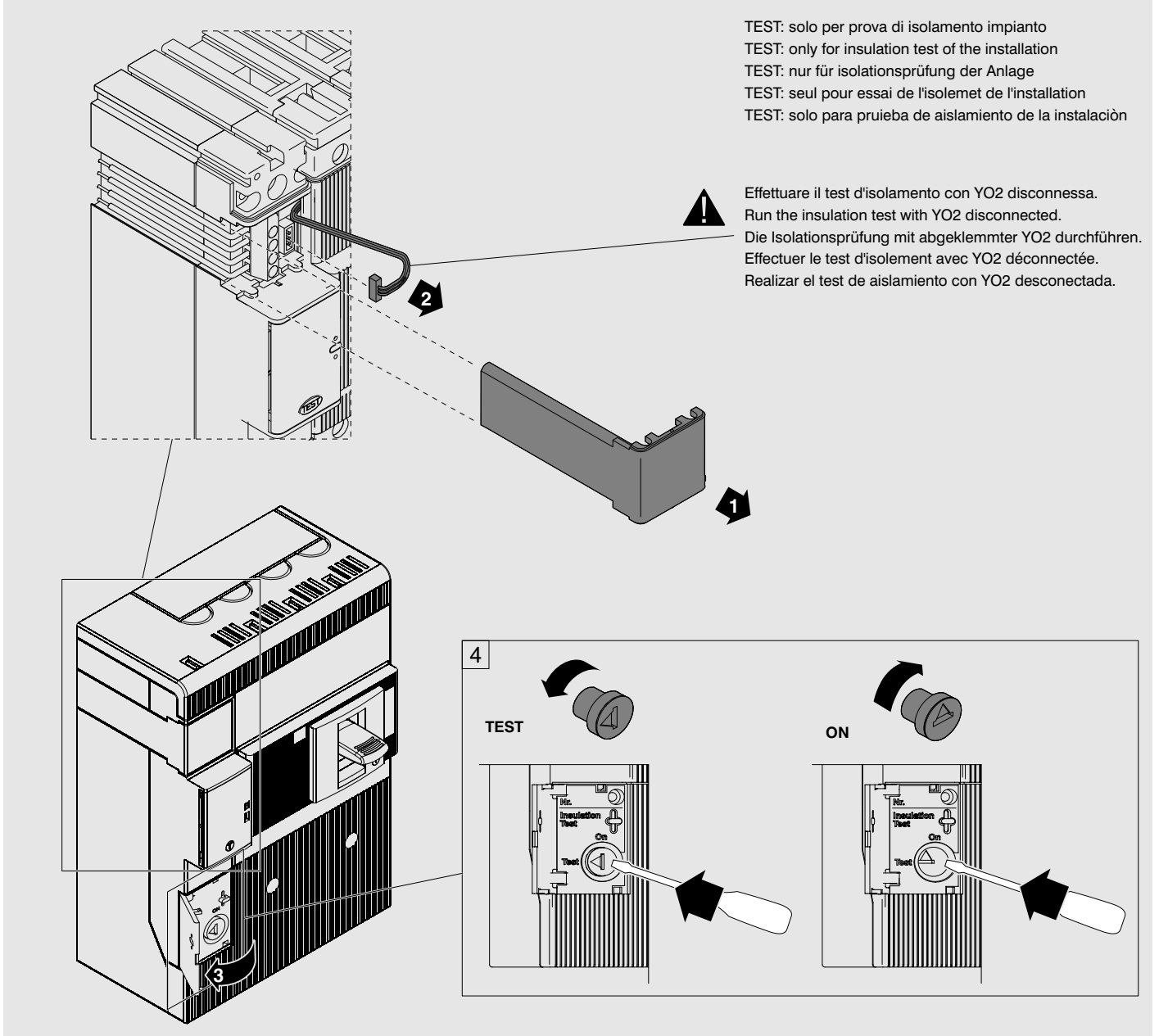
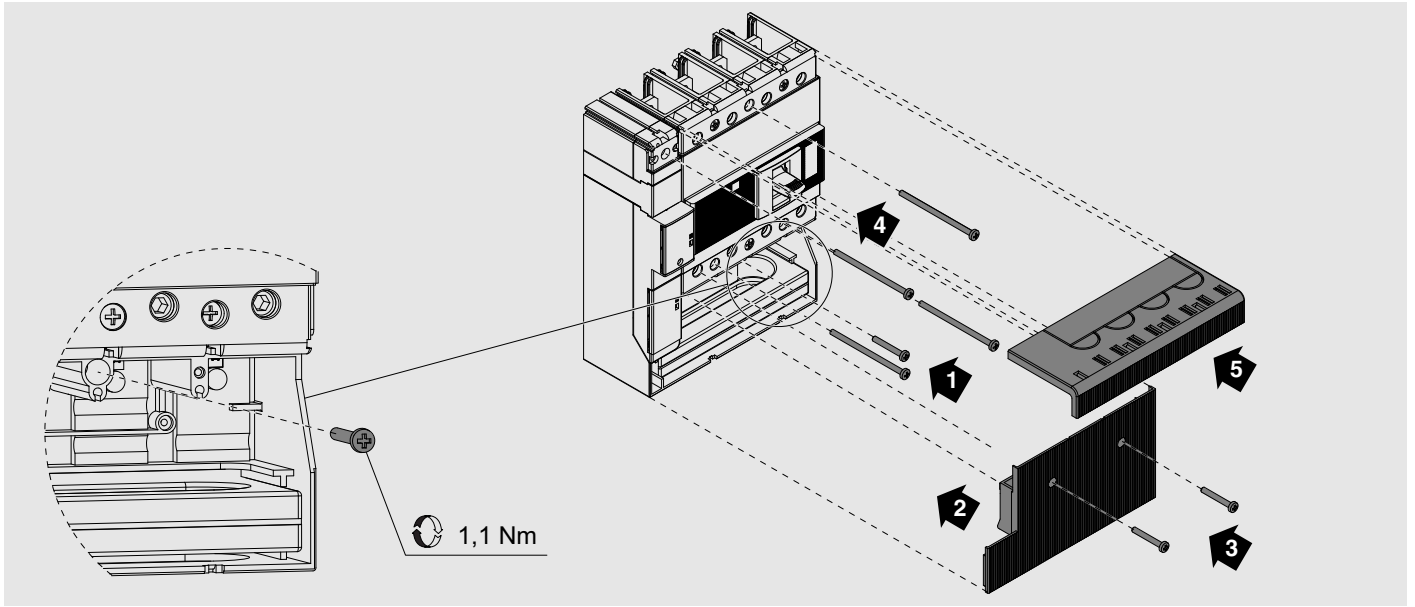

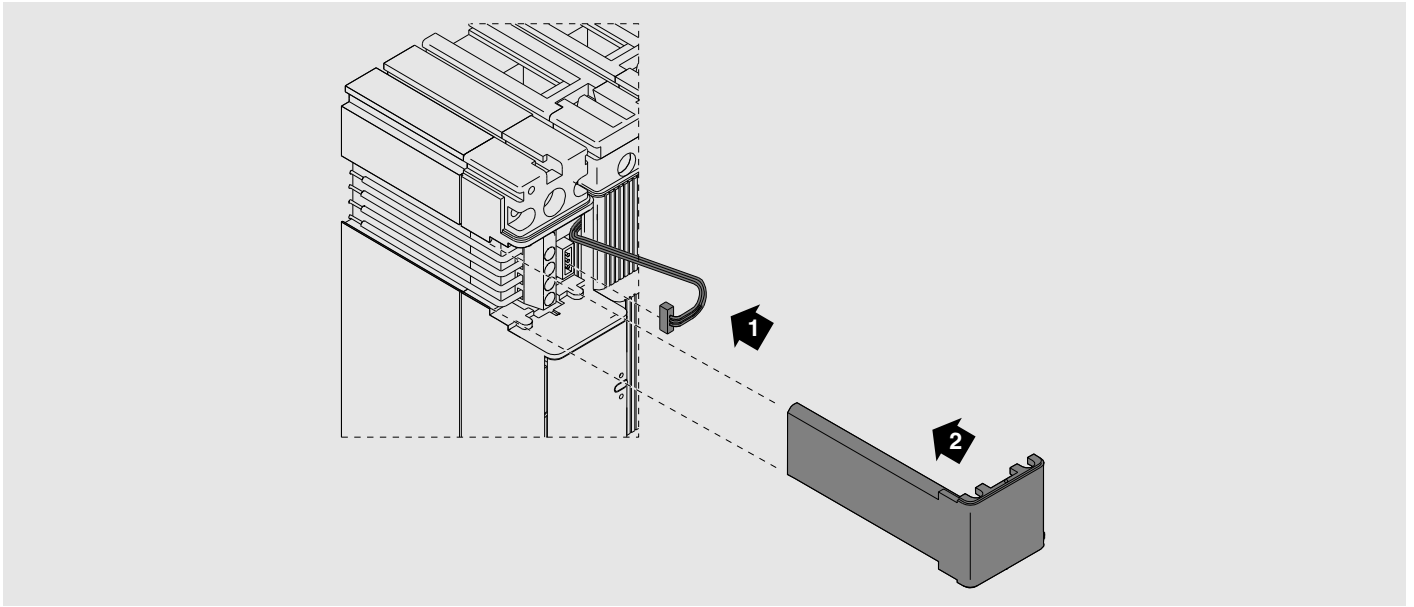

Spingere il pulsante test per almeno 3 secondi  
 Press the TEST button for at least 3 s  
 Die Taste TEST mindestens 3 s gedrückt halten  
 Appuyer sur le bouton TEST pendant au moins 3 s  
 Accionar el pulsador TEST durante por lo menos 3 seg

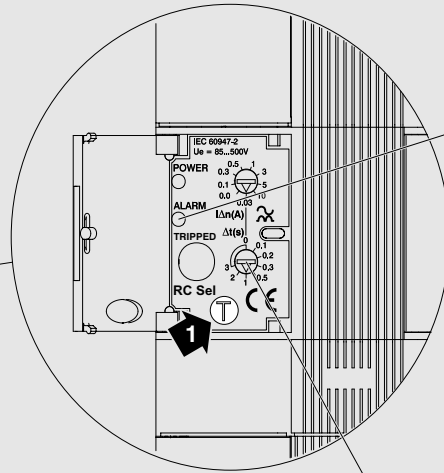
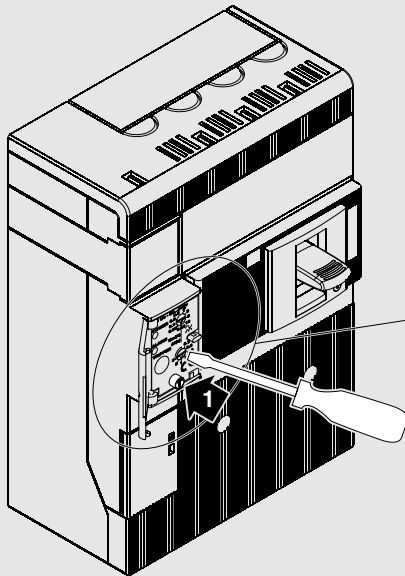

LED light fixed	PreAlarm
LED blinking	Alarm

IΔn: 1) 0,03 A => Δt = 0 s ONLY.  
 2) 0,05 ÷ 10 A => Δt = 0 ÷ 3 s max

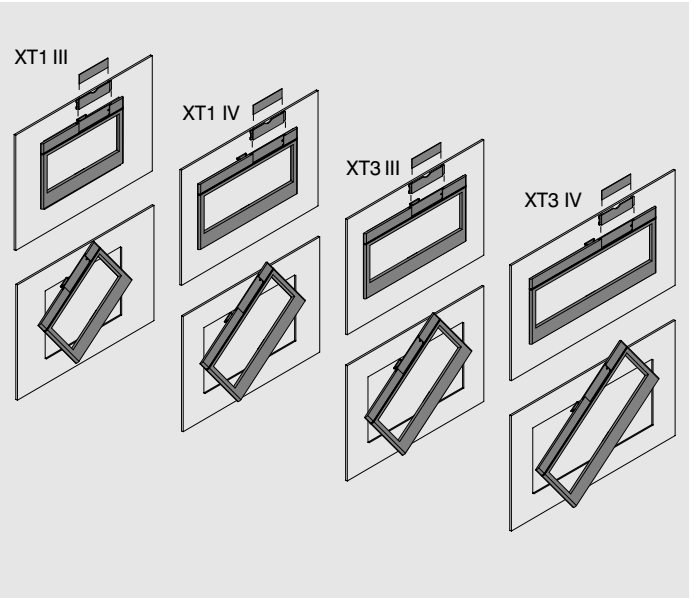
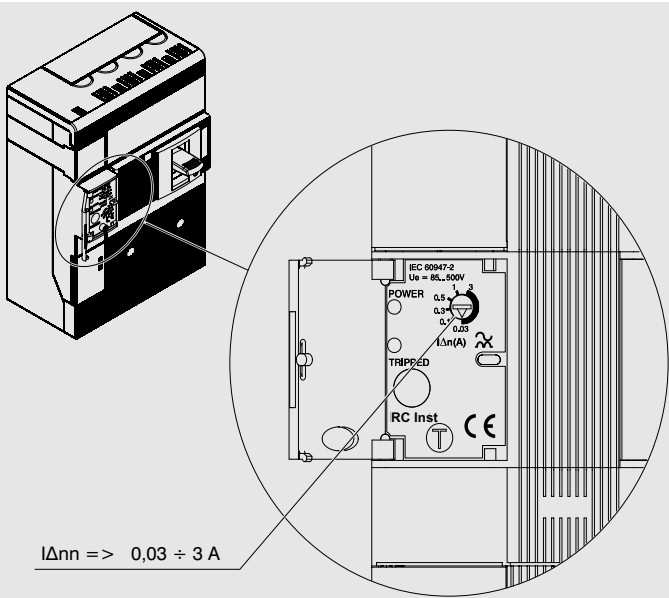

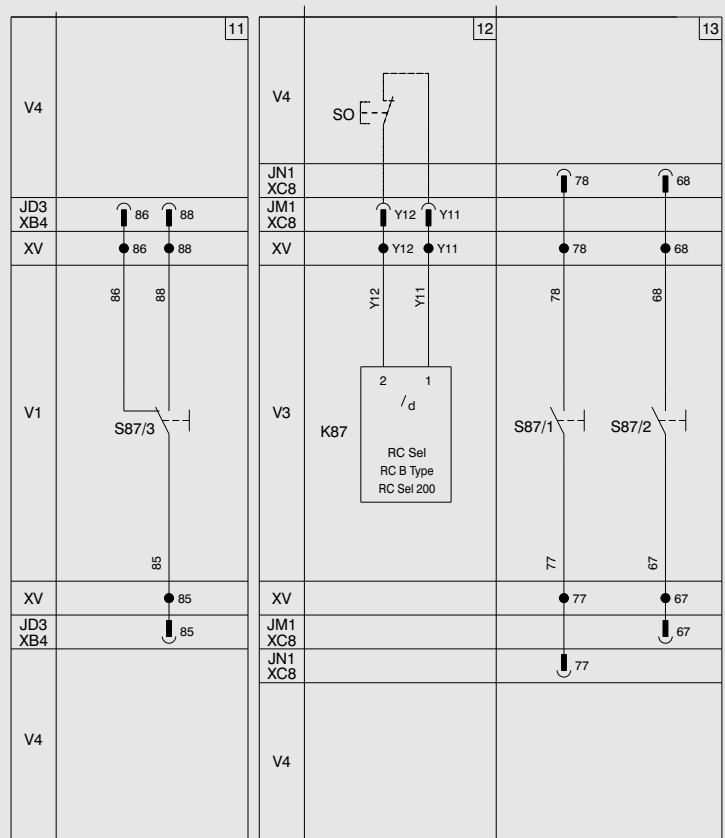
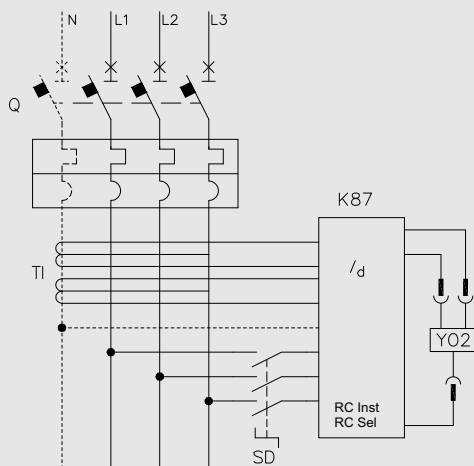

## 22

Con sganciatore differenziale alimentato premere il pulsante rosso di test 'T' del differenziale e verificare l'apertura dell'interruttore.

Press the red test button 'T' with the residual current release powered and check to make sure that the circuit-breaker opens.

Mit gespeistem Fehlerstromauslöser die rote Test-Taste T des Fehlerstromauslösers drücken und sicherstellen, dass der Leistungsschalter ausgeschaltet ist.

Le déclencheur différentiel étant alimenté appuyer sur le bouton rouge "T" du différentiel et vérifier l'ouverture du disjoncteur.

Con relé diferencial alimentado pulsar el pulsador rojo de test 'T' del diferencial y verificar la apertura del interruptor.

For more information please contact:

ABB S.p.A.  
 ABB SACE Division  
 Via Baioni, 35  
 24123 Bergamo - Italy  
 Phone: +39 035 395 111  
 Fax: +39 035 395 306 - 433

[www.abb.com](http://www.abb.com)