



Serie

# Silver - 76 RPT

## Especificaciones Técnicas

Carpintería Corredera

Cerco y Hoja Perimetral

Sección de Marco ..... 80 mm.

Sección de Hoja ..... 32 x 77 mm.

Galce de vidrio ..... Vidrios hasta 26 mm. (29 mm. de hueco)

Peso Máximo por Hoja : 160 Kg. ( 2 tándems por hoja )

Posibilidad de colocación de Herraje Multipunto Corredera

## Clasificación obtenida

Permeabilidad al aire*	CLASE	<b>3</b>
Estanqueidad al agua*	CLASE	<b>7A</b>
Resistencia al viento*	CLASE	<b>C5</b>
Transmitancia térmica**		<b>1.6</b> W/m <sup>2</sup> K
Transm. térmica Uf (Nudo lateral)^		<b>3.9</b> W/m <sup>2</sup> K
Aislamiento Acústico***		<b>38</b> (-1;-2)dB

\* Ventana de 2 hojas de 1230 x 1480 mm .

\*\* Ventana de 2 hojas de 1480 x 2180 mm ; Vidrio Ug: 0,6 W/m<sup>2</sup> K

\*\*\* Ventana de 2 hojas de 1250 x 1500 mm ; Vidrio 4+4.2 Silence/10/3+3.2 Silence

^ Según normativa UNE-EN ISO 10077-2

## Posibilidades de Apertura

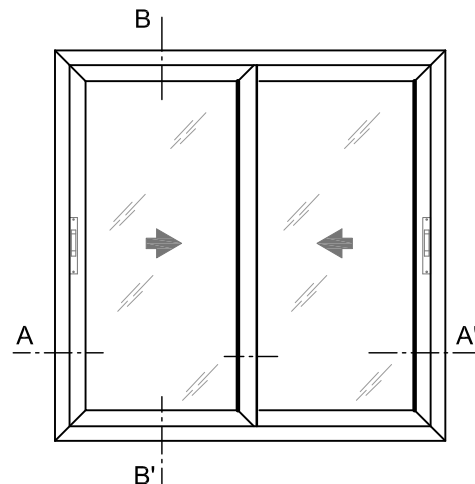
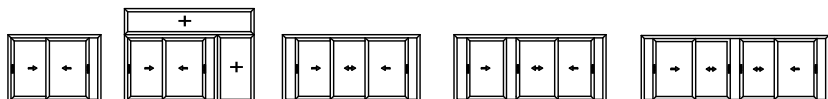

VENTANA DE 2 HOJAS CORREDERAS

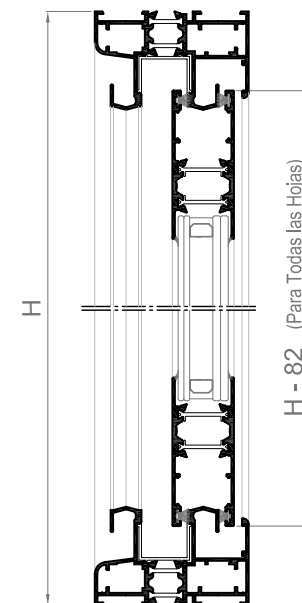

Sección B-B'

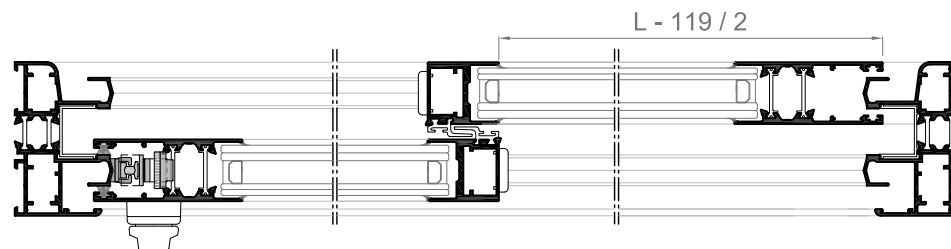

Sección A-A' / Hoja Minimalista

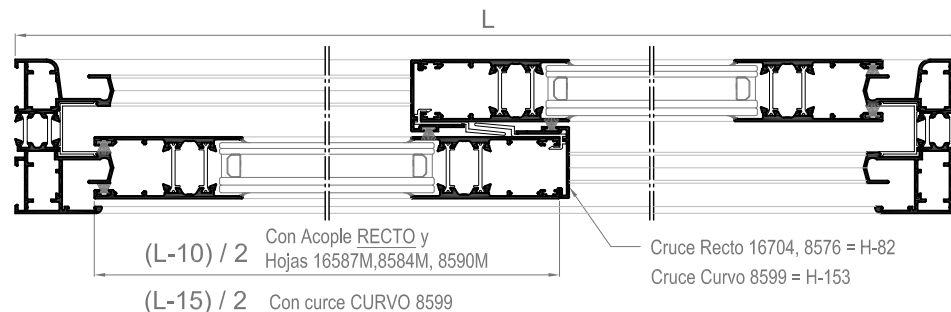

Sección A-A'

Los ensayos de las ventanas realizados por el grupo Alugom, que son cedidos para la obtención del marcado CE por parte del cliente, se han realizado con los perfiles y accesorios específicos y concretos propuestos por el grupo Alugom, que figuran en los manuales de fabricación de cada serie. Para más información consultar con la sección técnico-comercial del grupo Alugom.

# Perfiles

## Silver - 76 RPT

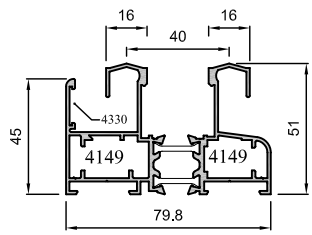

8064M

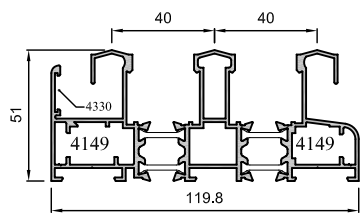

8065M

c/ útil 4386 con lengüeta de 17 (No Incl.) ó  
c/ útil 4192 (posterior a 2010).

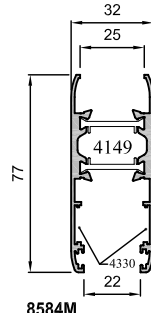

8584M

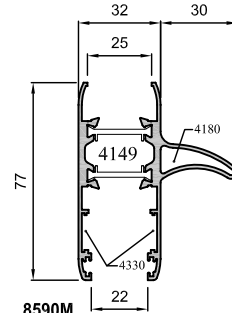

8590M

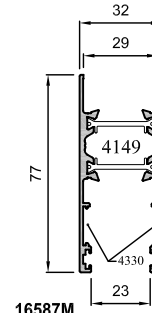

16587M

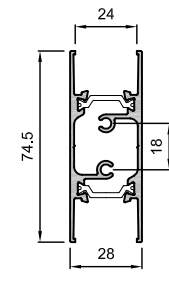

10005M

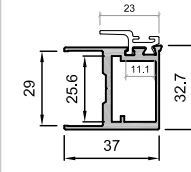

17259M

mecanizado manual

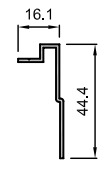

8577

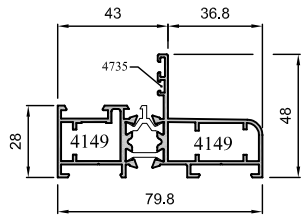

8062M

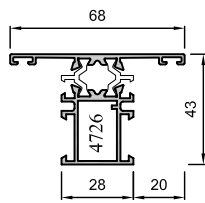

8865M

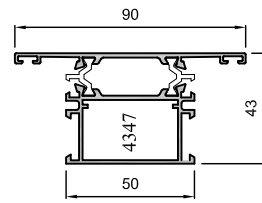

8810M

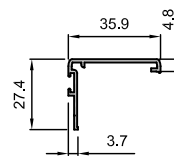

8576  
Cruce 4135

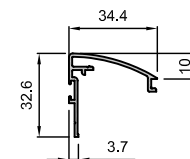

8599  
Cruce 4133

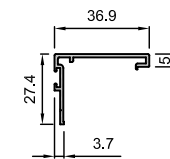

16704  
Acople para hoja recta (16587M)  
Cruce 4135

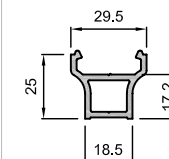

783  
6695

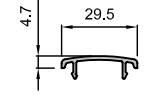

784  
6696

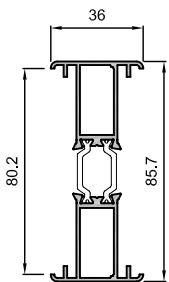

8099M

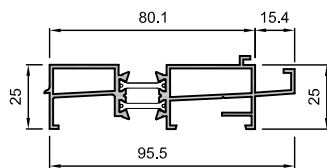

8619L

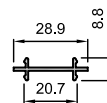

8589

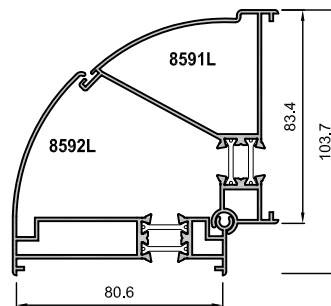

327  
1434

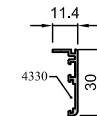
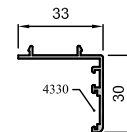

281  
1140

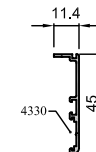

8629

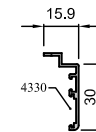

8832

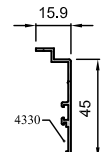

8630

# Accesorios

## Silver - 76 RPT

### Tirador

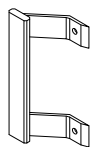

**4153**  
Tirador Series Silver

### Escuadras



**4149**  
Escuadra Cerco y Hoja



**4136**  
Escuadra Cerco 3 Carriles



**4330**  
Escuadra alineam. 15 mm.



**4735**  
Escuadra alineam. 2 mm.



**4109**  
Escuadra alineam. hojas



**4039**  
Escuadra inox. alineamiento

### Tapas

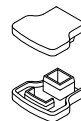

**4339**  
Jgo. tapas tirador postizo (783-4)

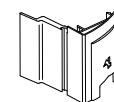

**4199**  
Emb. acople curvo (para 8599) (Jgo.4)



**4155**  
Emb. acople H. central

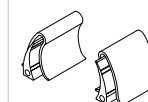

**4185**  
Juego tapas hoja tirador (8580)



**4337**  
Emb. salida agua c/membrana



**4035**  
Emb. salida agua

### Elementos de Cierre

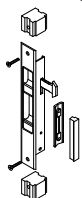

**4145**  
Cierre Embutido s/condena

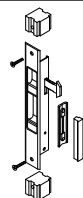

**4138**  
Cierre embutido c/condena

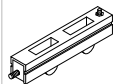

**4140**  
Rueda regulable 160Kg por hoja (2 tandem)



**4147**  
Rueda sencilla 80Kg por hoja (2 ruedas)

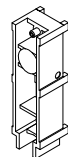

**4184**  
Tope Guiador (Jgo. 4)



**4197**  
Perfil aislante acople 4 hojas



**4134**  
Perfil aislante cerco



**4135**  
Perfil aisl. acople central recto



**4133**  
Perfil aisl. acople central curvo

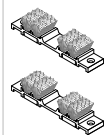

**4141**  
Cortavientos Silver-76

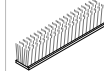

**2004**  
Cepillo Corr. 7x6 mm.



**2022**  
Cepillo Fin Seal 7x7 mm.



**3204**  
Cepillo Fin Seal 7x6.5 mm.



**4177**  
Cepillo Tri-Fin 7x6 mm.

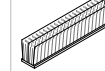

**4179**  
Cepillo Tri-Fin 7x7 mm.

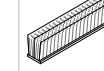

**4178**  
Cepillo Tri-Fin 7x6.5 mm.



**4176**  
Valvula de drenaje

### Cierre Multipunto c/ llave

E : 15 mm

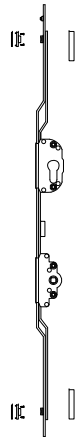

**4186**  
Cierre multipunto con llave  
Longitud = 1600 mm.

### Cierre Multipunto

E : 7.5 mm

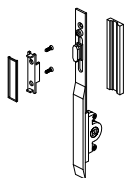

**4193**  
Cierre multipunto 125 (monopunto)

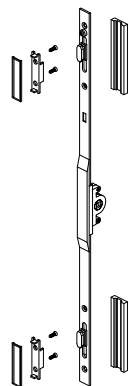

**4187**  
Cierre multipunto H= 668 - 1068

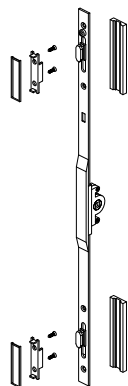

**4188**  
Cierre multipunto H= 1069-1868

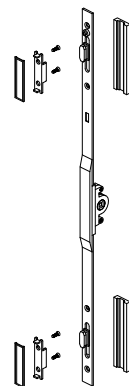

**4189**  
Cierre multipunto H> 1869

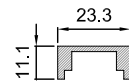

Calzo grande

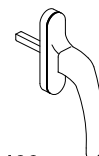

**4190**  
Manilla cuadradillo 7 mm.

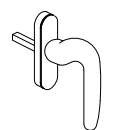

**4858(D) / 4859(I)**  
Manilla corredera acodada cuadradillo 7 mm.



**4979**  
Seguro antielev. multipunto



**5086**  
Manilla recta acodada

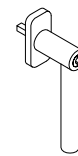

**5080**  
Manilla recta c/llave

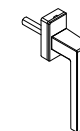

**5191**  
Manilla Kora c/cuadr. 7mm



**5079**  
Manilla recta cuadradillo 7 mm

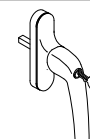

**5183**  
Manilla cuadradillo 7 mm c/llave



**5389**  
Manilla Toulon c/cuadr. 7 mm.

### KITS

**4181**  
KIT Escuadra Hoja Minimalista

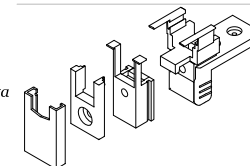

### Utilaje

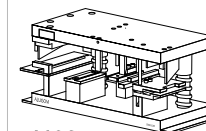

**4192**  
Util Silver-76/76 rpt

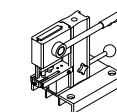

**4386**  
Util manual Silver-76/76 rpt