

STREET [O₃] LED

GEWISS

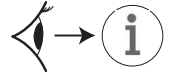

CE

IP66



$t_{min} -25^{\circ}C$

$t_a +25^{\circ}C$

⊗	Kg	h		
1x16 LEDs	8,5	Max 15m	0,21m ²	0,11m ²
2x16 LEDs	9,1			
3x16 LEDs	9,7			
4x16 LEDs	10,3			
5x16 LEDs	10,9			

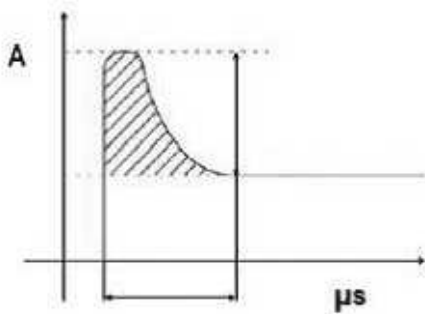

⊗	I _{LED} (mA)	Inrush current peak and width
STREET [O₃] STAND-ALONE		
1x16 LEDs	700	130 A / 165 µs
2x16 LEDs	700	130 A / 165 µs
3x16 LEDs	700	35 A / 1000 µs
4x16 LEDs	700	35 A / 1000 µs
STREET [O₃] STAND-ALONE / DIMMABLE 1-10 V		
1x16 LEDs	530	20 A / 400 µs
2x16 LEDs	530	70 A / 120 µs
3x16 LEDs	530	130 A / 140 µs
4x16 LEDs	530	130 A / 140 µs
5x16 LEDs	530	130 A / 140 µs
STREET [O₃] Bi-power with self-learning		
1x16 LEDs	530	130 A / 140 µs
2x16 LEDs	530	130 A / 140 µs
3x16 LEDs	530	130 A / 140 µs
4x16 LEDs	530	130 A / 140 µs
5x16 LEDs	530	130 A / 140 µs

STREET OPTICS			CYCLE AND PEDESTRIAN OPTIC
ST 1	ST 2	ST 3	
3,4 m	3 m	3 m	3,6 m

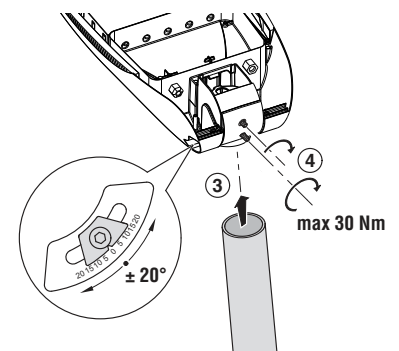
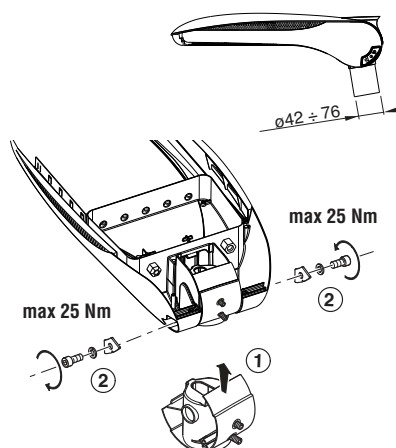
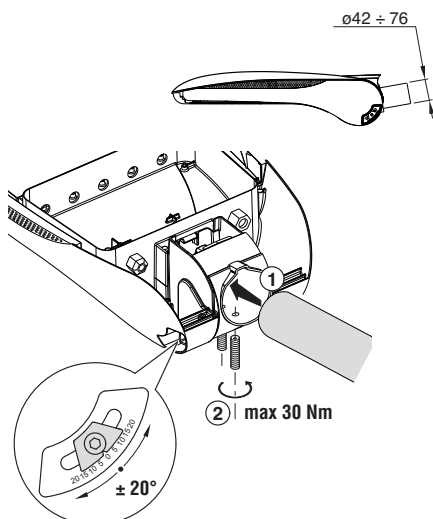

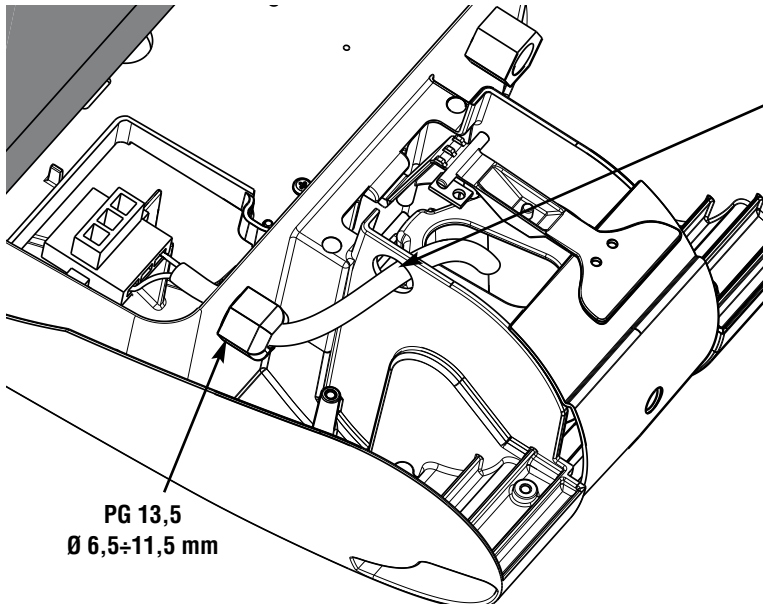
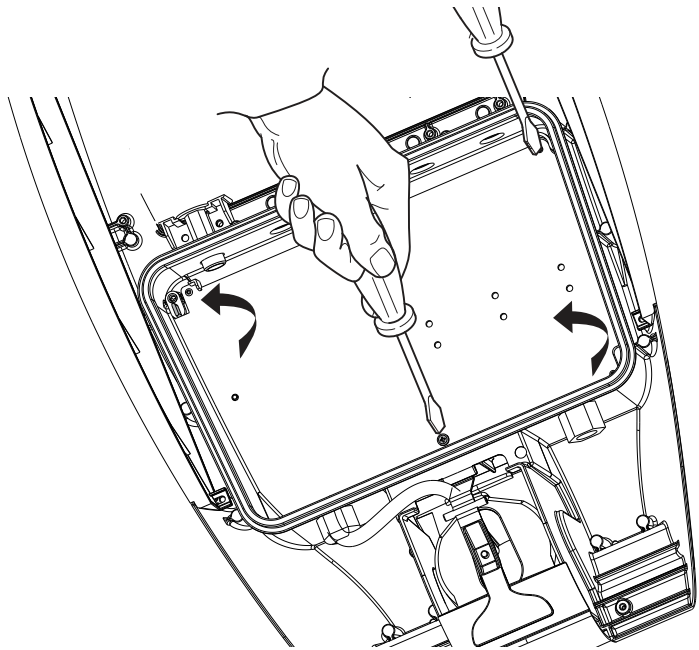
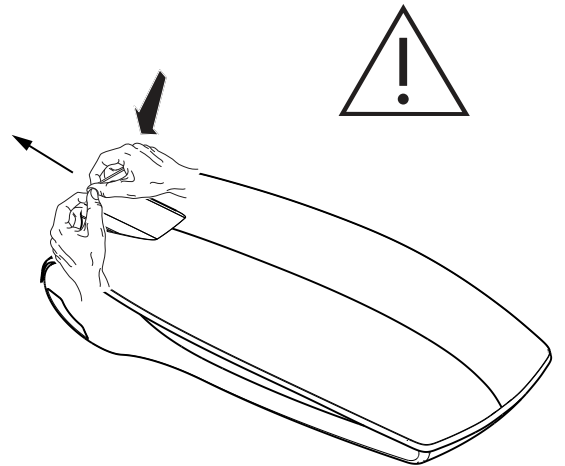
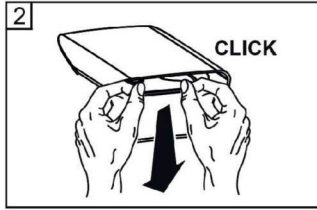
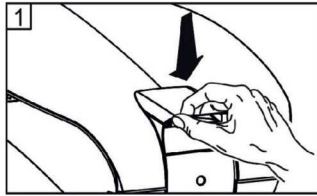
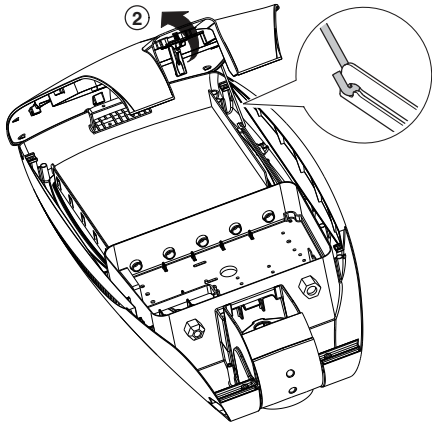

PG 13,5
Ø 6,5÷11,5 mm

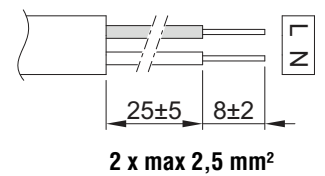

DIMMING 1-10V

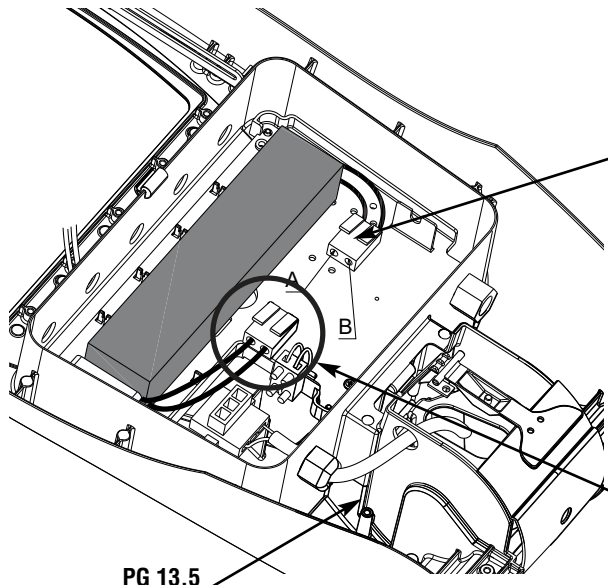

PG 13,5
Ø 6,5÷11,5 mm

3x16/4x16/5x16 LED

	I = 530 mA
	I = 410 mA
	I = 350 mA

2x16 LED

	I = 530 mA
	I = 340 mA
	I = 420 mA

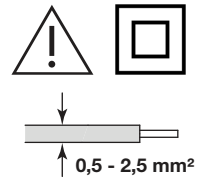
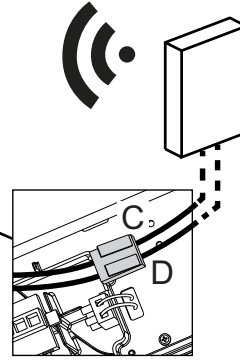

MODEL 1x16 LED - 350mA < I < 700mA

	6	5	4	3	2	1
OFF						
ON						
SEC	6	5	4	3	2	1
350 mA	-	-	-	-	-	-
500 mA	ON	-	-	-	-	-
550 mA STANDARD	-	ON	-	-	-	-
650 mA	ON	-	-	ON	-	-
700 mA	ON	ON	-	-	-	-

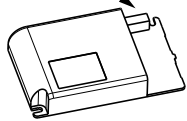

STREET O3 3x16 LED / 4x16 LED - 700mA

ON				
OFF				
SEC	1	2	3	4
200 mA	-	-	-	-
250 mA	ON	-	-	-
300 mA	-	ON	-	-
350 mA	ON	ON	-	-
400 mA	-	-	ON	-
450 mA	ON	-	ON	-
500 mA	-	ON	ON	-
550 mA	ON	ON	ON	-
600 mA	-	-	-	ON
650 mA	ON	-	-	ON
700 mA	-	ON	-	ON

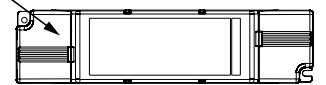

BI-POWER

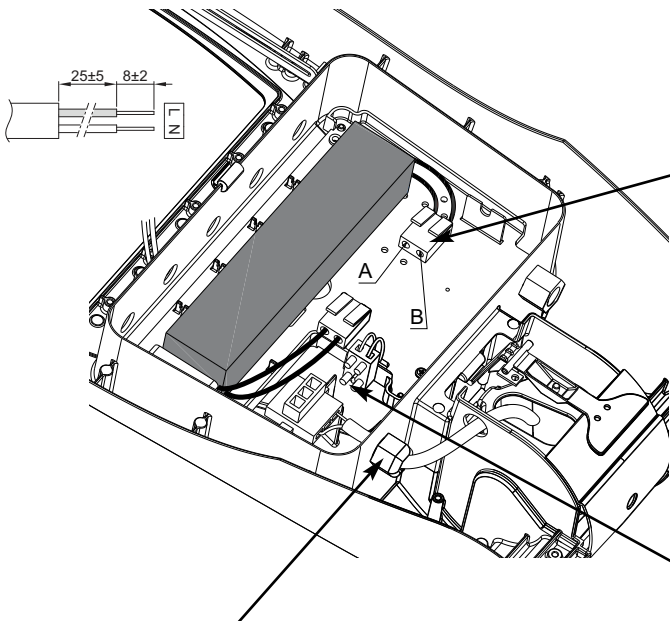

PG 13,5
Ø 6,5÷11,5 mm

	I = 530 mA	82 lm/W	10600 lm
	I = 410 mA	88 lm/W	9005 lm
	I = 350 mA	93 lm/W	8010 lm

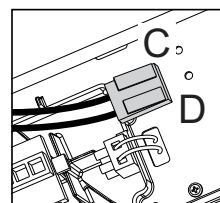

	Dim level (%)	T-dim (hrs)	T-down (hrs)	After Midpoint (hrs)
	50	6	2	4
	66	6	0	6
	50	8	2	6

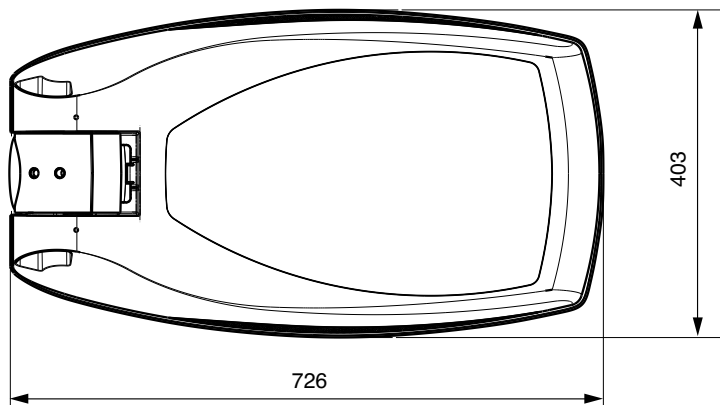
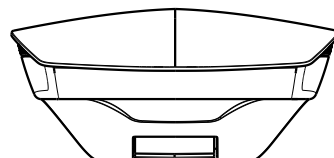
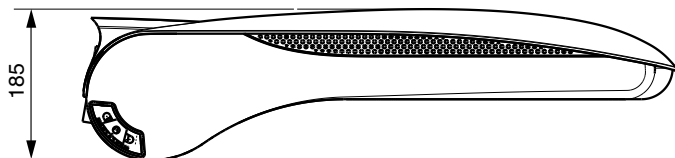
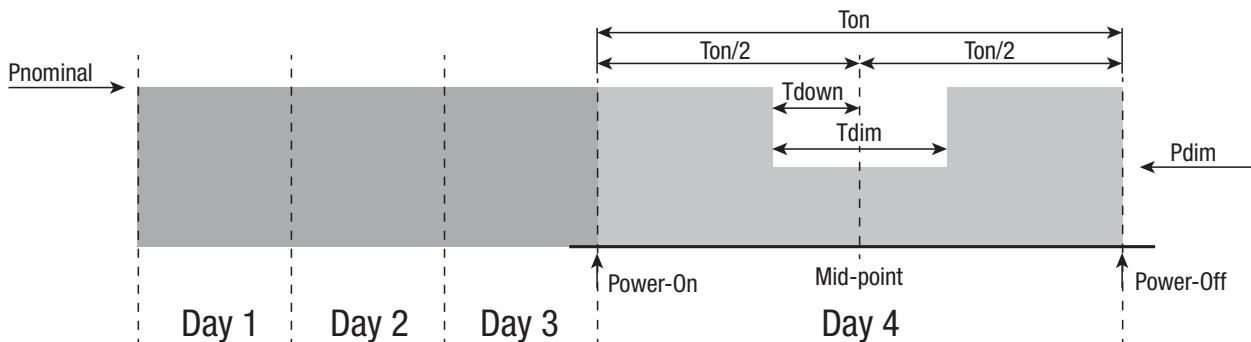

Ai sensi delle Decisioni e delle Direttive Europee applicabili, si informa che il responsabile dell'immissione del prodotto sul mercato Comunitario è:
 According to the applicable Decisions and European Directives, the responsible for placing the apparatus on the Community market is:

GEWISS S.p.A. Via A.Volta, 1 IT-24069 Cenate Sotto (BG) Italy Tel: +39 035 946 111 Fax: +39 035 946 270 E-mail: qualitymarks@gewiss.com



+39 035 946 111
 8.30 - 12.30 / 14.00 - 18.00
 lunedì ÷ venerdì - monday ÷ friday



+39 035 946 260



sat@gewiss.com
www.gewiss.com