



DESCRIPTION

**RVAZ2**

24V electromotive floating (3 points) or ON/OFF actuator to drive Pettinaroli's **PICV 92H 1 1/2"**.

Equipped with autostroke.

Connection M30x1,5 ring nut and adaptable to Pettinaroli's standards through specific adaptor.

DIMENSIONS

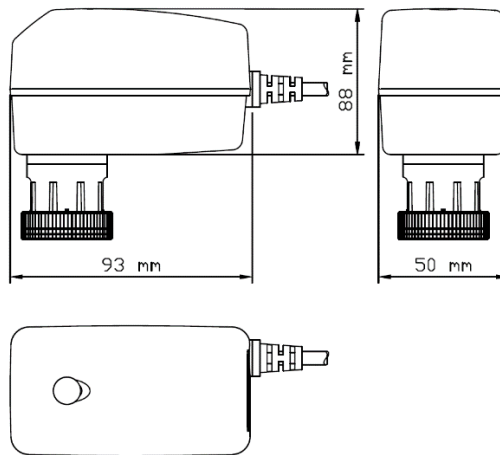

TECHNICAL FEATURES

<i>Type</i>	Floating or ON/OFF	<i>Temperature ambient range</i>	0 °C / 50 °C (non condensing)
<i>Supply voltage</i>	24V AC/DC ± 15%	<i>Umidity ambient range</i>	0% / 95% RH (non condensing)
<i>Inrush current</i>	1,6 A	<i>IP class</i>	IP54
<i>Power consumption</i>	2 W / 6 VA	<i>Manual override</i>	By 4 mm Allen key
<i>Stroke</i>	1 – 8,5 mm	<i>Connection cable</i>	3 x 0,25 mm <sup>2</sup> (halogen free)
<i>Running time</i>	5,5 s/mm	<i>Cable lenght</i>	1,5 m
<i>Actuating force</i>	200 N	<i>Adaptor</i>	0A748X (not included)
<i>Visual position indicator</i>	LED		

The RVAZ2 electromotive actuator is used to drive in floating mode (3 points) or in ON/OFF mode pressure independent control valves controlling heating and cooling system by means of BMS (Building Management System) or suitable thermostat able to manage 24V signals. For more details about the wiring see the specific chapter below.

In order to install the actuator on Pettinaroli's **92H 1 1/2"** valves it is necessary to use a suitable adapter (**0A748X**) which is not included with the actuator and must be purchased separately.



Adaptor **0A748X**

**ELECTRICAL CONNECTIONS**

Electrical connections are different to the type of command desired:

**Floating mode (3 points)**

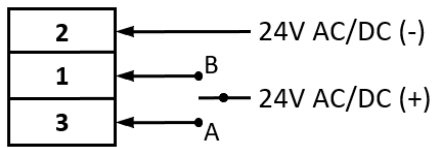

**ON/OFF mode**

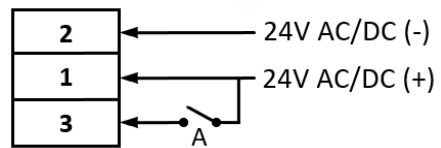

1	2	3	A	B
Black	White	Red	Stem extension	Stem retraction

**OPERATING STATUS INDICATIONS**

The RVAZ2 electromotive actuator is equipped with a two color LED (red/green) which allows to evaluate the operating status of the actuator in accordance with the table below:

	LED off	No power supply
	Green LED fixed light	Actuator moving, under operation
	Green LED quick flash	Stroke adaption
	Green LED slow flash (Flash twice + Off 2 sec.)	Bottom dead center detected (0 % of the stroke)
	Green LED slow flash (Flash twice + On 1 sec. + Off 1 sec.)	Top dead center detected (100 % of the stroke)
	Red LED fixed light	Error on the internal limit switches / more than 2 errors
	Red LED quick flash	Error on one of the internal limit switches
	Red LED slow flash (Flash twice + Off 2 sec.)	Auto stroke adapt fault

**INSTALLATION**

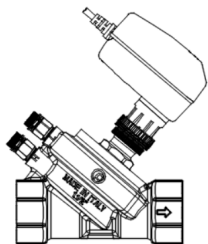

Fig. 1

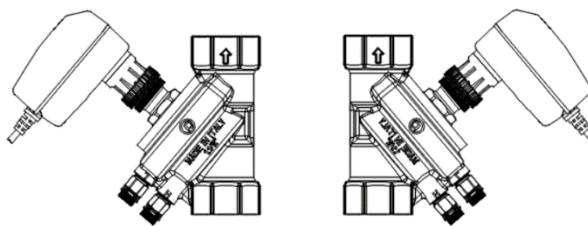

Fig. 2

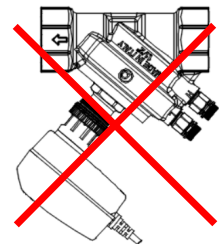

Fig. 3

- For electrical safety reasons the RVAZ2 electromotive actuator has to be installed as shown by pictures 1 and 2. The upside down installation shown in picture 3 must be avoided. Always install the actuator with the pin in fully retracted position;
- Do not power the actuator if not installed on the valve;
- Tighten the connecting ring by hand only. Do not use any tools;
- Keep a clear space of 15 cm over the actuator to access it, if required.

**APPROVALS**



**MANUAL OVERRIDE**

If necessary it is possible to manually operate the actuator by using a 4 mm Allen key supplied in pair with the actuator itself. To do this you need to follow the following steps:

1. Remove the manual override rubber seal placed on the front of the actuator;
2. Insert the Allen key to turn the existing lead screw. In particular, turn it **CLOCKWISE** to extend the actuator stem (closing the valve) while turn it **COUNTERCLOCKWISE** to retract the actuator stem (opening the valve).

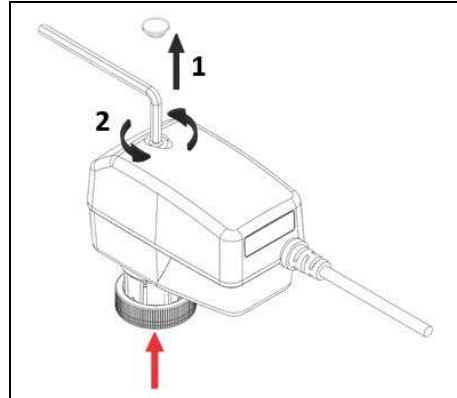
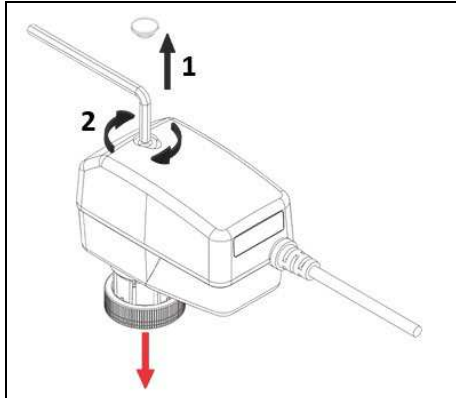

**!** When the manual rubber override seal is open, IP54 rating no longer applies.