

An abstract graphic on the left side of the slide, composed of numerous overlapping, semi-transparent blue rectangular and polygonal shapes. These shapes are arranged in a way that creates a sense of depth and perspective, appearing to recede towards a bright white light source at the center of the composition. The colors range from light sky blue to deep navy blue.

HCL

RAV_GM1AT8_224-280

20-02-2020

RAV_GM1AT8_224-280

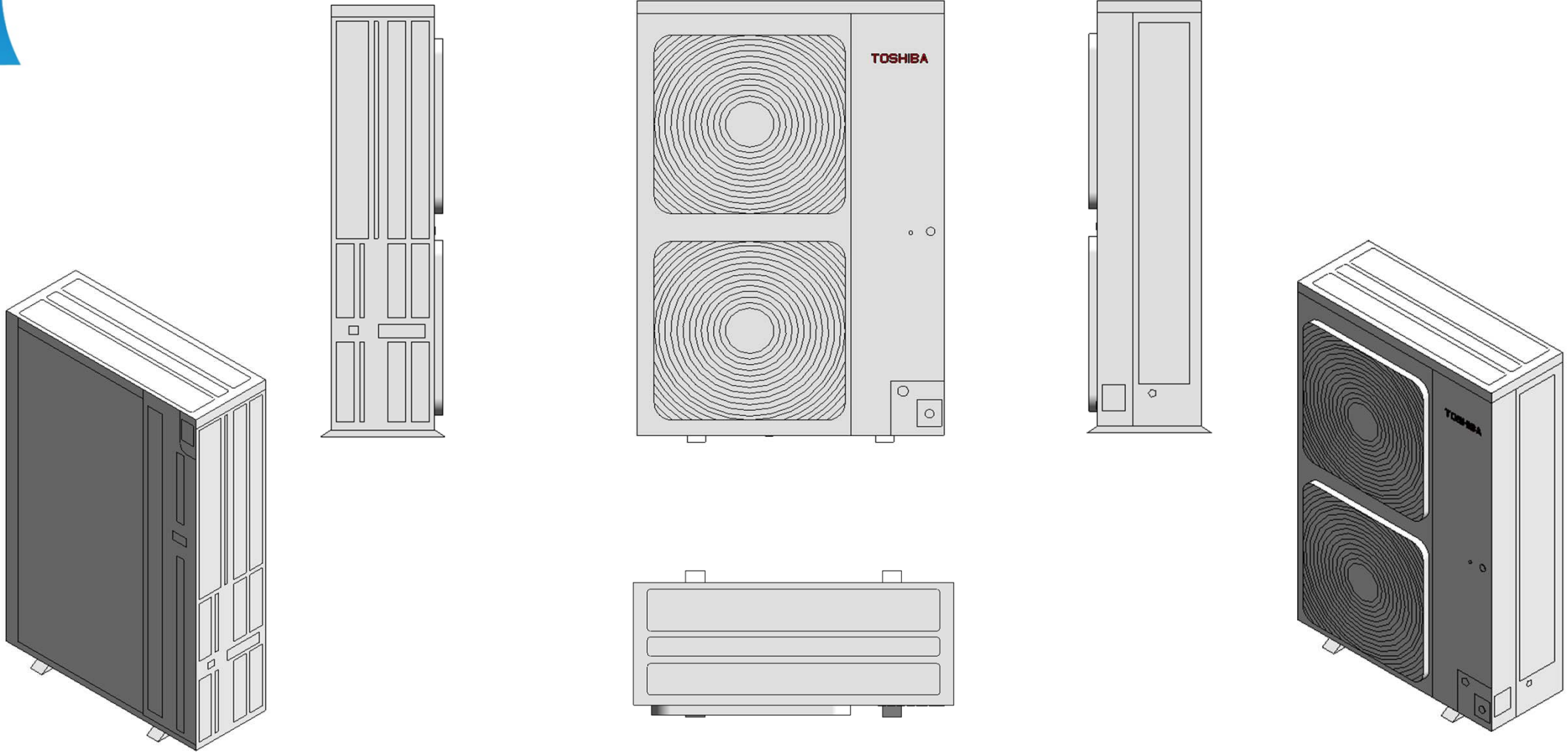

RAV_GM1AT8_224-280

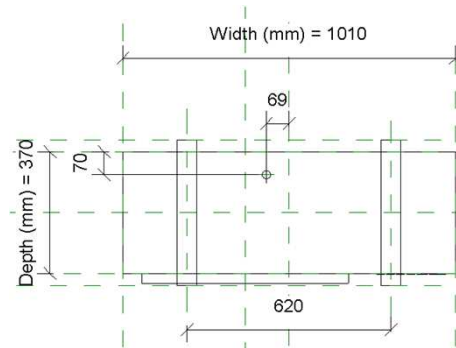
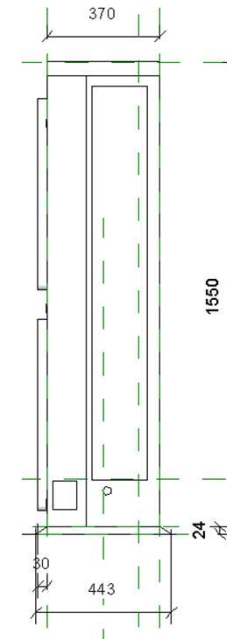
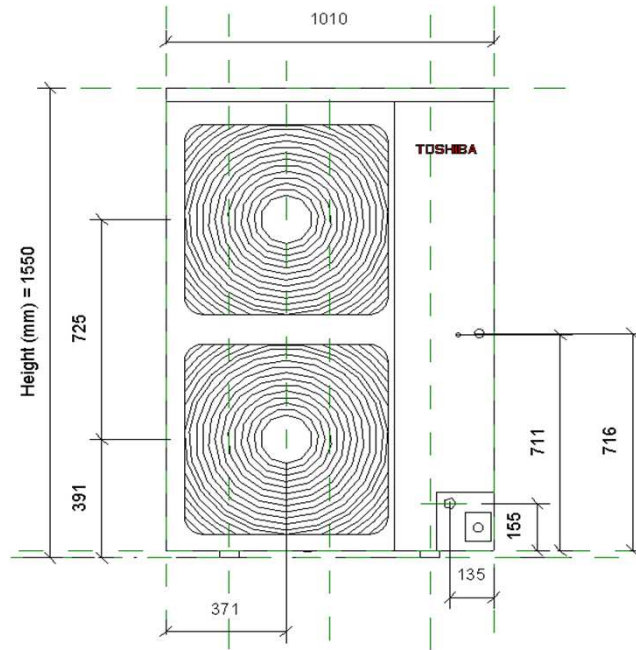
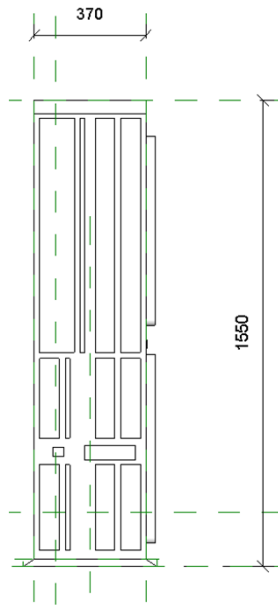

RAV_GM1AT8_224-280_Service Area

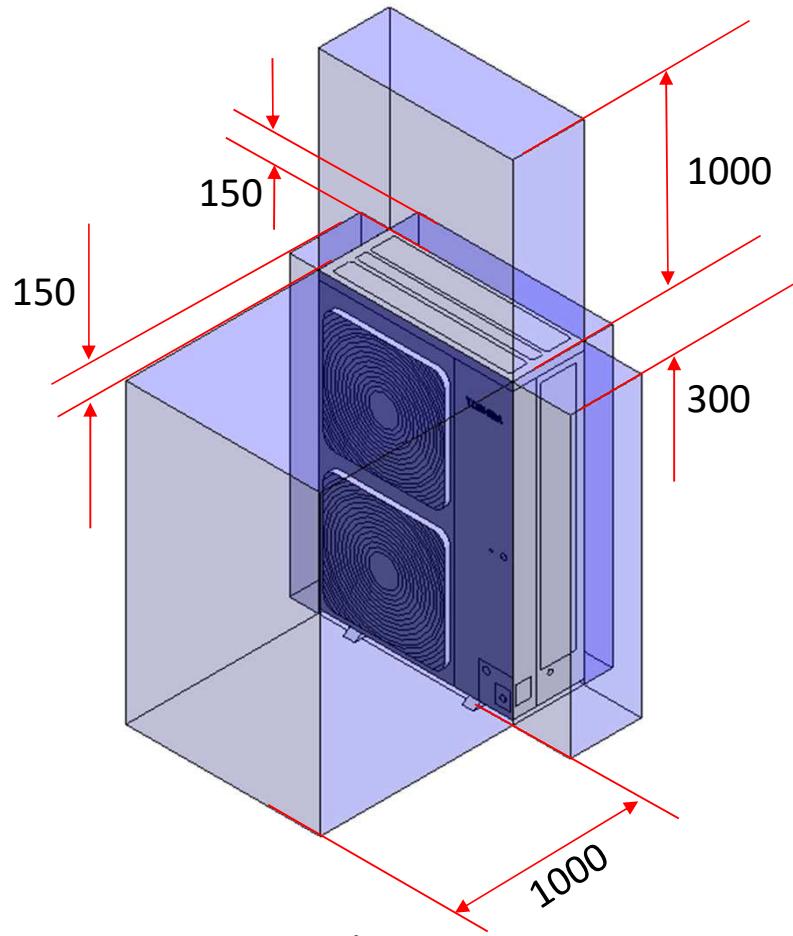

RAV_GM1AT8_224-280

Visibility	
Service Area (default)	<input checked="" type="checkbox"/>
Front Clearance (mm) (default)	1000.0
Rear Clearance (default)	150.0
Right Side Clearance (mm) (default)	300.0
Left Side Clearance (mm) (default)	150.0
Top Clearance (mm)	1000.0

Service Clearance ON

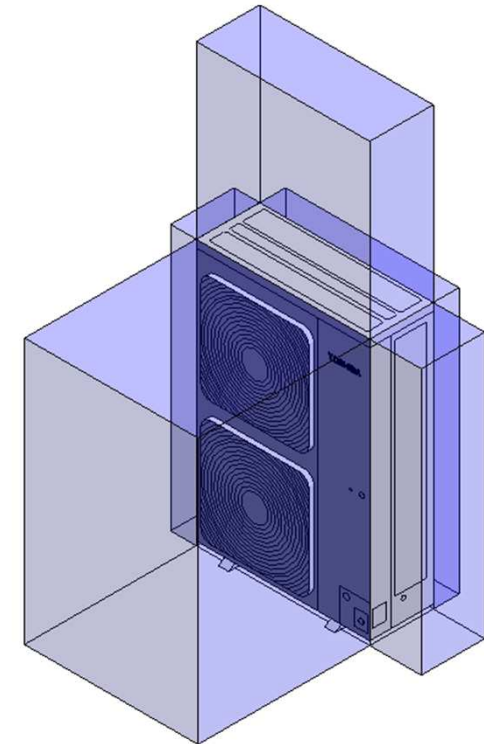

RAV_GM1AT8_224-280

Visibility	
Service Area (default)	<input type="checkbox"/>
Front Clearance (mm) (default)	1000.0
Rear Clearance (default)	150.0
Right Side Clearance (mm) (default)	300.0
Left Side Clearance (mm) (default)	150.0
Top Clearance (mm)	1000.0

Service Clearance OFF

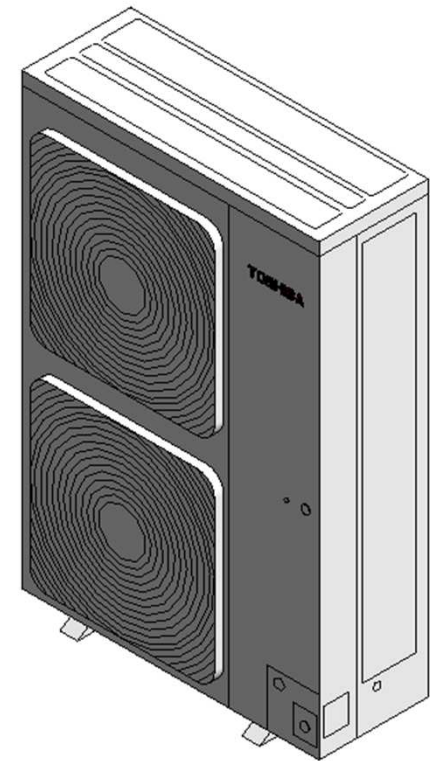

Electrical Connector

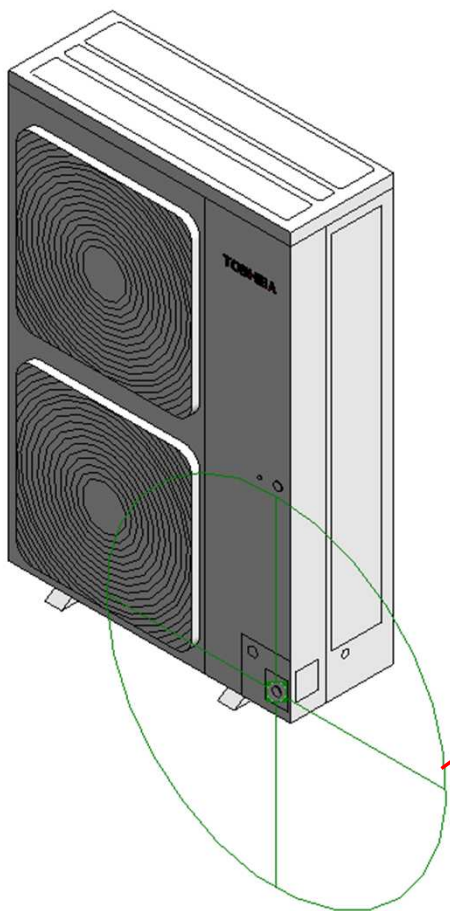

Connector Element (1) Edit Type	
Electrical - Loads	
System Type	Power - Unbalanced
Number of Poles	1
Power Factor State	Lagging
Load Classification	Other
Load Sub-Classification Motor	<input type="checkbox"/>
Voltage	0.00 V
Apparent Load Phase 1	0.00 VA
Apparent Load Phase 2	0.00 VA
Apparent Load Phase 3	0.00 VA
Power Factor	1.000000
Identity Data	
Utility	<input type="checkbox"/>
Connector Description	ELECTRICAL CONNECTOR

Pipe Connectors

Properties	
R	
Connector Element (1) Edit Type	
Dimensions	
Diameter	12.7
Mechanical	
K Coefficient	0.000000
Flow Factor	0.000000
Flow Configuration	Calculated
Flow Direction	In
Loss Method	Not Defined
Allow Slope Adjustments	<input type="checkbox"/>
System Classification	Hydronic Supply
Mechanical - Flow	
Flow	0.00 L/s
Pressure Drop	0.00 Pa
Identity Data	
Utility	<input type="checkbox"/>
Connector Description	Refrigerant pipe connecting port-Liquid Side (dia 12.7mm)

Properties	
R	
Connector Element (1) Edit Type	
Dimensions	
Diameter	28.6
Mechanical	
K Coefficient	0.000000
Flow Factor	0.000000
Flow Configuration	Calculated
Flow Direction	Out
Loss Method	Not Defined
Allow Slope Adjustments	<input type="checkbox"/>
System Classification	Hydronic Return
Mechanical - Flow	
Flow	0.00 L/s
Pressure Drop	0.00 Pa
Identity Data	
Utility	<input type="checkbox"/>
Connector Description	Refrigerant pipe connecting port-Gas Side (dia 28.6mm)

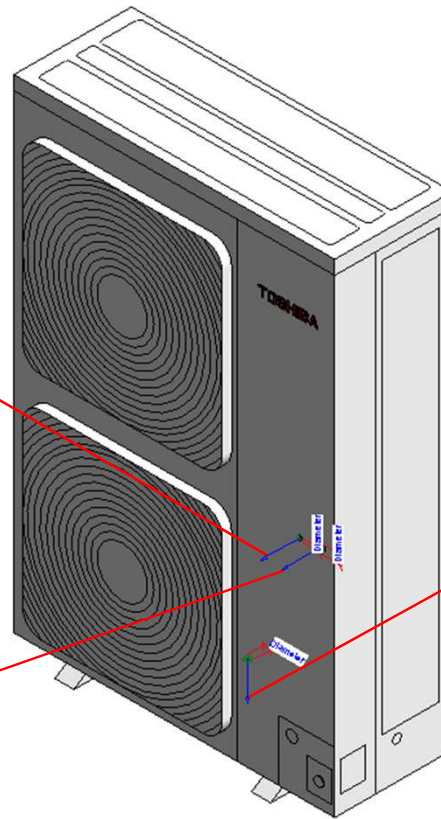

Properties	
R	
Connector Element (1) Edit Type	
Dimensions	
Diameter	25.0
Mechanical	
K Coefficient	0.000000
Flow Factor	0.000000
Flow Configuration	Calculated
Flow Direction	Out
Loss Method	Not Defined
Allow Slope Adjustments	<input type="checkbox"/>
System Classification	Vent
Mechanical - Flow	
Flow	0.00 L/s
Pressure Drop	0.00 Pa
Identity Data	
Utility	<input type="checkbox"/>
Connector Description	DRAIN PORT

RAV-GM2241AT8-E

Family Types		
Type name: RAV-GM2241AT8-E		
Search parameters		
Parameter	Value	Formula
Materials and Finishes		
Red	Colour RGB-250 000 000	=
White	Colour RGB-255 255 255	=
Electrical		
MOCP (A)	25	=
MCA (A)	-	=
Running current-Cooling	-	=
Power consumption-Cooling	-	=
Running current-Heating	-	=
Power consumption-Heating	-	=
Frequency (Hz)	-	=
Voltage (V)	-	=
Maximum current	18.0	=
Dimensions		
Height (mm)	1550.0	=
Width (mm)	1010.0	=
Depth (mm)	370.0	=
Piping diameter (mm)-Gas	28.6	=
Piping diameter (mm)-Liquid	12.7	=
Drain pipe(mm)	-	=
Duct diameters(mm)	-	=
Mechanical - Flow		
Static pressure	-	=
Sound pressure - Cooling/Heating (dB)-High	58 / 60	=
Sound pressure - Cooling/Heating (dB)-Mid+	-	=
Sound pressure - Cooling/Heating (dB)-Mid	-	=
Sound pressure - Cooling/Heating (dB)-Low+	-	=
Sound pressure - Cooling/Heating (dB)-Low	-	=
Airflow m3/h-Cooling/Heating	9150	=
Mechanical - Loads		
Rated Capacity kW-Cooling/Heating	20.0 / 22.4	=
Rated Power Consumption kW-Cooling/Heating	-	=
Rated efficiency-EER / COP	-	=
Energy Analysis		
Energy class-Cooling/Heating	-	=
Seasonal Efficiency-SEER / SCOP	-	=
Pdesigh-Cooling/Heating	-	=

Family Types		
Type name: RAV-GM2241AT8-E		
Search parameters		
Parameter	Value	Formula
Visibility		
Service Area (default)	<input type="checkbox"/>	=
Front Clearance (mm) (default)	1000.0	=
Rear Clearance (default)	150.0	=
Right Side Clearance (mm) (default)	300.0	=
Left Side Clearance (mm) (default)	150.0	=
Top Clearance (mm)	1000.0	=
Other		
Compressor detail - Type	Hermetic DC twin rotary compressor	=
Compressor detail - Motor output (kW)	-	=
Operating range - Cooling (°C)	-15 - 46	=
Operating range - Heating (°C)	-20 - 15	=
Refrigerant information	-	=
Weight (Kg)	142	=
Identity Data		
Article Description	R32 Big DI 3PH	=
Article Type	RAV-GM2241AT8-E	=
Assembly Code		=
Base Family Version		=
CB-NL Class		=
Content Supplier URL	www.hcltech.com	=
Copyright	©Toshiba / HCL	"©Toshiba / HCL"
Cost		=
Custom	<input type="checkbox"/>	=
Description	R32 Big DI 3PH	=
EMCS	4	"4"
ETIM Article Class	EC001213	"EC001213"
Family Version		=
GLN		=
GTIN		=
Internal Art. No.		=
Keynote		=
MEPcontent Class	HEATPUMP	"HEATPUMP"
Manufacturer	Toshiba	"Toshiba"
Manufacturer Art. No.	RAV-GM2241AT8-E	=
Manufacturer URL	https://www.toshiba-carrier.co.jp/global/	=
Model	RAV-GM2241AT8-E	=
Product Line		=
Revit Version		=
Stabu Code		=
Type Comments		=
Type Image		=
URL	https://www.toshiba-carrier.co.jp/global/	=
Watermarked By		=
Wholesaler		=
Wholesaler Art. No.		=

RAV-GM2801AT8-E

Family Types		
Type name: RAV-GM2801AT8-E		
Search parameters		
Parameter	Value	Formula
Materials and Finishes		
Red	Colour RGB-250 000 000	=
White	Colour RGB-255 255 255	=
Electrical		
MOCP (A)	25	=
MCA (A)	-	=
Running current-Cooling	-	=
Power consumption-Cooling	-	=
Running current-Heating	-	=
Power consumption-Heating	-	=
Frequency (Hz)	-	=
Voltage (V)	-	=
Maximum current	23	=
Dimensions		
Height (mm)	1550.0	=
Width (mm)	1010.0	=
Depth (mm)	370.0	=
Piping diameter (mm)-Gas	28.6	=
Piping diameter (mm)-Liquid	12.7	=
Drain pipe(mm)	-	=
Duct diameters(mm)	-	=
Mechanical - Flow		
Static pressure	-	=
Sound pressure - Cooling/Heating (dB)-High	61 / 63	=
Sound pressure - Cooling/Heating (dB)-Mid+	-	=
Sound pressure - Cooling/Heating (dB)-Mid	-	=
Sound pressure - Cooling/Heating (dB)-Low+	-	=
Sound pressure - Cooling/Heating (dB)-Low	-	=
Airflow m3/h-Cooling/Heating	10890	=
Mechanical - Loads		
Rated Capacity kW-Cooling/Heating	23.5 / 27.0	=
Rated Power Consumption kW-Cooling/Heating	-	=
Rated efficiency-EER / COP	-	=
Energy Analysis		
Energy class-Cooling/Heating	-	=
Seasonal Efficiency-SEER / SCOP	-	=
Pdesigh-Cooling/Heating	-	=

Family Types		
Type name: RAV-GM2801AT8-E		
Search parameters		
Parameter	Value	Formula
Visibility		
Service Area (default)	<input type="checkbox"/>	=
Front Clearance (mm) (default)	1000.0	=
Rear Clearance (default)	150.0	=
Right Side Clearance (mm) (default)	300.0	=
Left Side Clearance (mm) (default)	150.0	=
Top Clearance (mm)	1000.0	=
Other		
Compressor detail - Type	Hermetic DC twin rotary compressor	=
Compressor detail - Motor output (kW)	-	=
Operating range - Cooling (*C)	-15 - 46	=
Operating range - Heating (*C)	-20 - 15	=
Refrigerant information	-	=
Weight (Kg)	142	=
Identity Data		
Article Description	R32 Big DI 3PH	=
Article Type	RAV-GM2801AT8-E	=
Assembly Code		=
Base Family Version		=
CB-NL Class		=
Content Supplier URL	www.hcltech.com	=
Copyright	©Toshiba / HCL	"©Toshiba / HCL"
Cost		=
Custom	<input type="checkbox"/>	=
Description	R32 Big DI 3PH	=
EMCS	4	"4"
ETIM Article Class	EC001213	"EC001213"
Family Version		=
GLN		=
GTIN		=
Internal Art. No.		=
Keynote		=
MEPcontent Class	HEATPUMP	"HEATPUMP"
Manufacturer	Toshiba	"Toshiba"
Manufacturer Art. No.	RAV-GM2801AT8-E	=
Manufacturer URL	https://www.toshiba-carrier.co.jp/global/	=
Model	RAV-GM2801AT8-E	=
Product Line		=
Revit Version		=
Stabu Code		=
Type Comments		=
Type Image		=
URL	https://www.toshiba-carrier.co.jp/global/	=
Watermarked By		=



Thank You