

# VRF\_MMD1SPHY\_3-12

18-01-2021

# VRF\_MMD1SPHY\_3-12

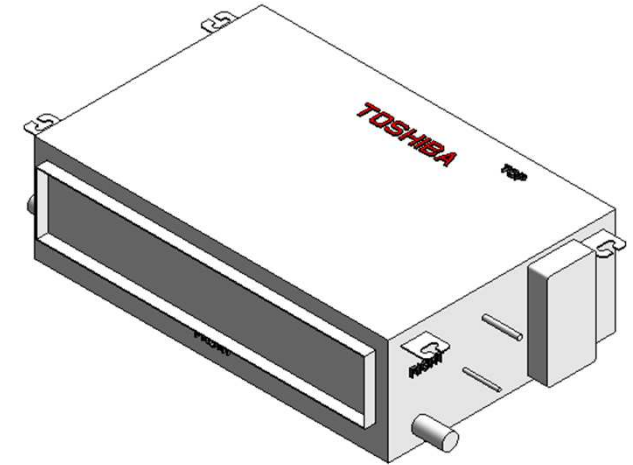
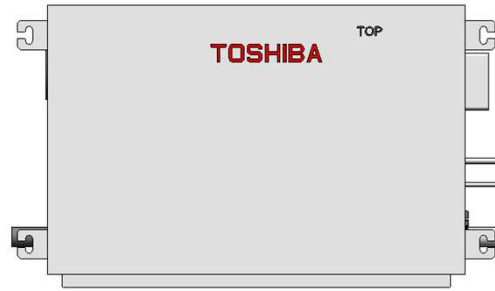
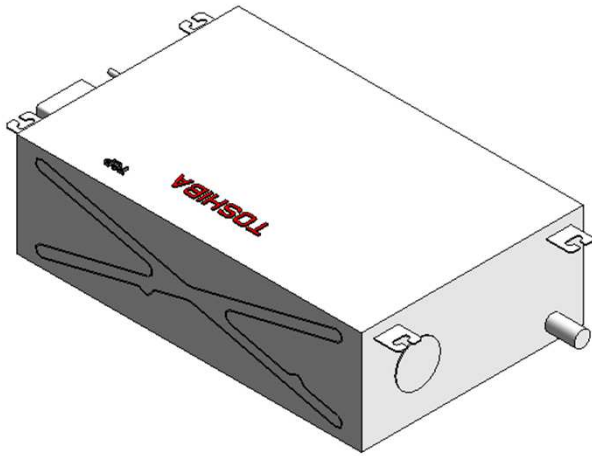
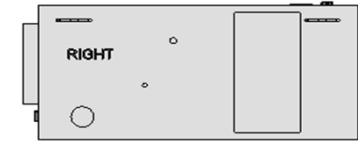
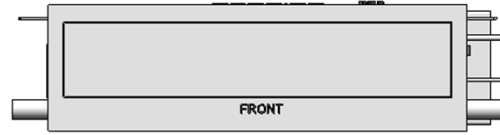

# VRF\_MMD1SPHY\_3-12

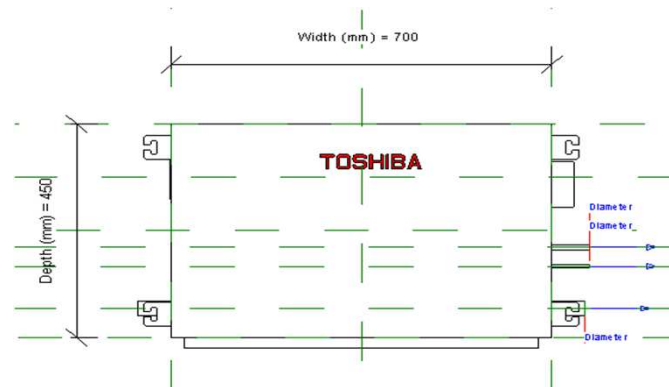
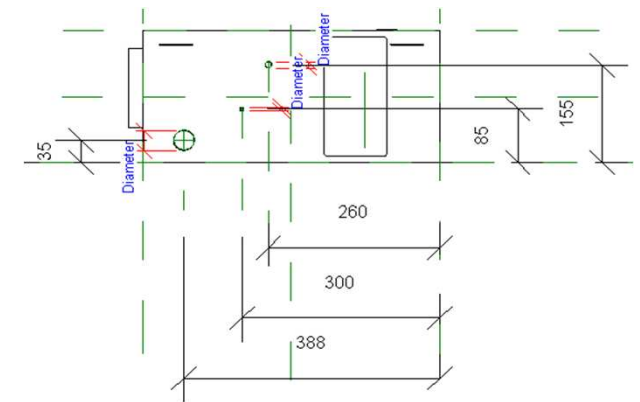
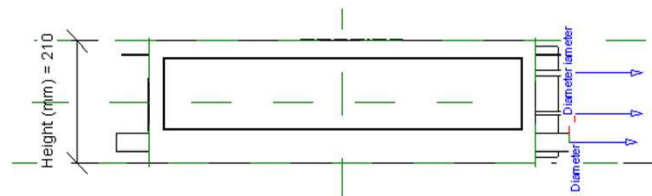
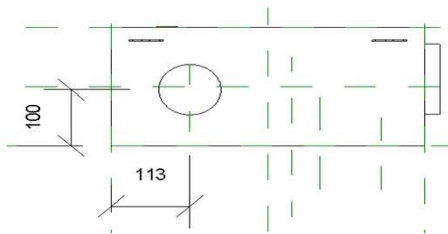

# VRF\_MMD1SPHY\_3-12\_Service Area

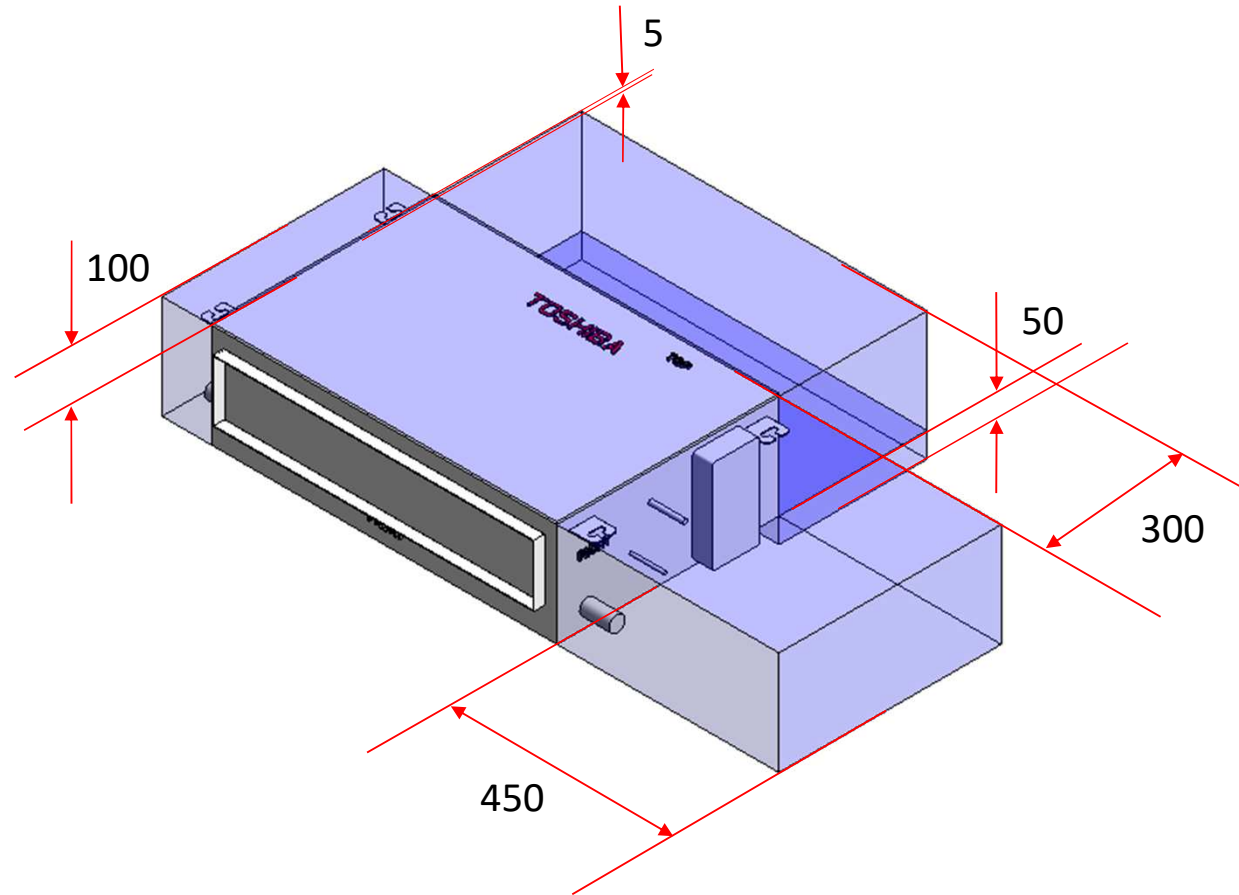

# VRF\_MMD1SPHY\_3-12

Visibility	
Service Area (default)	<input checked="" type="checkbox"/>
Top Clearance (mm) (default)	5.0
Right Side Clearance (mm) (default)	450.0
Left Side Clearance (mm) (default)	100.0
Rear side (Under air intake) (default)	50.0
Back Clearance (mm) (default)	300.0

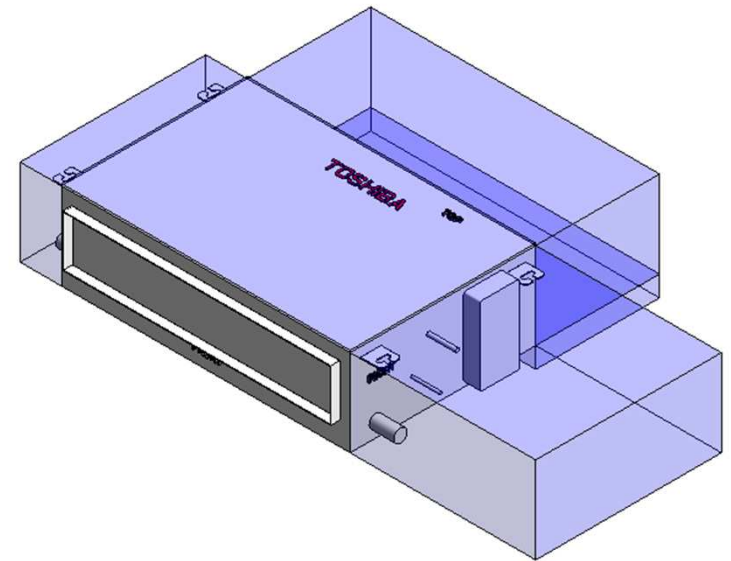

Service Clearance ON

# VRF\_MMD1SPHY\_3-12

Visibility	
Service Area (default)	<input type="checkbox"/>
Top Clearance (mm) (default)	5.0
Right Side Clearance (mm) (default)	450.0
Left Side Clearance (mm) (default)	100.0
Rear side (Under air intake) (default)	50.0
Back Clearance (mm) (default)	300.0

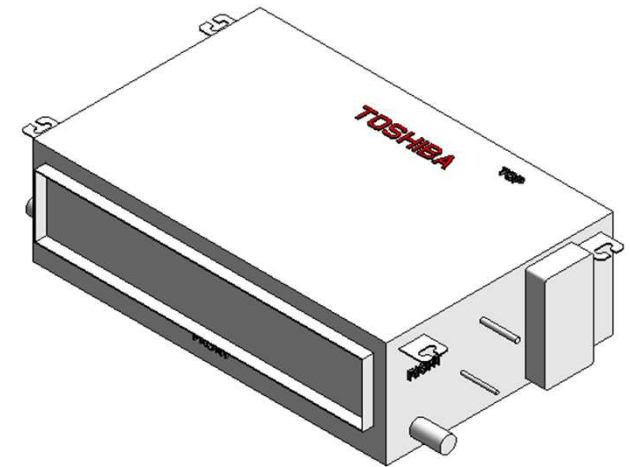

Service Clearance OFF

# Electrical Connector

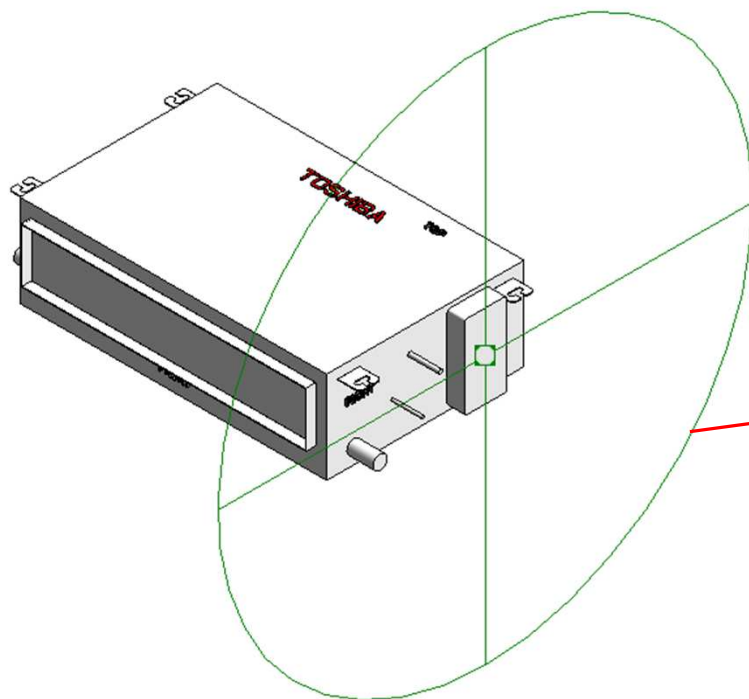

Properties

R

Connector Element (1) Edit Type

Electrical - Loads	
System Type	Power - Unbalanced
Number of Poles	1
Power Factor State	Lagging
Load Classification	Other
Load Sub-Classification Motor	<input type="checkbox"/>
Voltage	0.00 V
Apparent Load Phase 1	0.00 VA
Apparent Load Phase 2	0.00 VA
Apparent Load Phase 3	0.00 VA
Power Factor	1.000000
Identity Data	
Utility	<input type="checkbox"/>
Connector Description	ELECTRICAL CONNECTOR

# Pipe Connectors

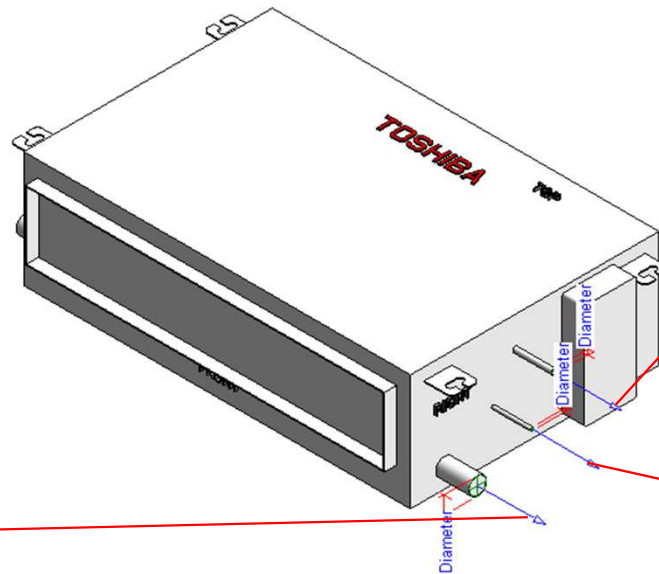

Properties	
<b>R</b>	
Connector Element (1)	
Dimensions	
Diameter	32.0
Mechanical	
K Coefficient	0.000000
Flow Factor	0.000000
Flow Configuration	Calculated
Flow Direction	Out
Loss Method	Not Defined
Allow Slope Adjustments	<input type="checkbox"/>
System Classification	Vent
Mechanical - Flow	
Flow	0.00 L/s
Pressure Drop	0.00 Pa
Identity Data	
Utility	<input type="checkbox"/>
Connector Description	DRAIN PORT 32mm

Properties	
<b>R</b>	
Connector Element (1)	
Dimensions	
Diameter	9.5
Mechanical	
K Coefficient	0.000000
Flow Factor	0.000000
Flow Configuration	Calculated
Flow Direction	Out
Loss Method	Not Defined
Allow Slope Adjustments	<input type="checkbox"/>
System Classification	Hydronic Return
Mechanical - Flow	
Flow	0.00 L/s
Pressure Drop	0.00 Pa
Identity Data	
Utility	<input type="checkbox"/>
Connector Description	HYDRONIC RETURN (GAS) PORT @ 9.5 mm

Properties	
<b>R</b>	
Connector Element (1)	
Dimensions	
Diameter	6.4
Mechanical	
K Coefficient	0.000000
Flow Factor	0.000000
Flow Configuration	Calculated
Flow Direction	In
Loss Method	Not Defined
Allow Slope Adjustments	<input type="checkbox"/>
System Classification	Hydronic Supply
Mechanical - Flow	
Flow	0.00 L/s
Pressure Drop	0.00 Pa
Identity Data	
Utility	<input type="checkbox"/>
Connector Description	HYDRONIC SUPPLY (LIQUID) PORT @ 6.4 mm



# MMD-UP0031SPHY-E

## Family Types

Type name: MMD-UP0031SPHY-E

Search parameters

Parameter	Value	Formula
<b>Materials and Finishes</b>		
Red	Colour RGB-255 000 000	"
White	Colour RGB-255 255 255	"
<b>Electrical</b>		
MOCP (A)	15	"
MCA (A)	0.49	"
Running current-Cooling (A)	0.34/ 0.36	"
Power consumption-Cooling (Kw)	0.018	"
Running current-Heating (A)	0.34/ 0.36	"
Power consumption-Heating (Kw)	0.018	"
Frequency (Hz)	50Hz 220-240V	"
Voltage (V)	60Hz 208-230V	"
Starting current (A)	0.60/ 0.63	"
<b>Dimensions</b>		
Height (mm)	210.0	"
Width (mm)	700.0	"
Depth (mm)	450.0	"
Piping diameter (mm)-Gas	9.5	"
Piping diameter (mm)-Liquid	6.4	"
Drain pipe(mm)	VP25(OD:32mm)	"
Duct diameter (mm)	-	"
<b>Mechanical - Flow</b>		
Static pressure	10-20-30-40-50	"
Factory default	10	"
Sound pressure dB(A)-High	29	"
Sound pressure dB(A)-Mid	27	"
Sound pressure dB(A)-Low	25	"
Airflow (m3/h)-High	410	"
Airflow (m3/h)-Mid	380	"
Airflow (m3/h)-Low	360	"
<b>Mechanical - Loads</b>		
Rated Power Consumption W-High	-	"
Rated Power Consumption W-Mid	-	"
Rated Power Consumption W-Low	-	"
Seasonal & Rated efficiency	-	"
Part load	-	"
Capacities kW-Cooling	0.9	"
Capacities kW-Heating	1	"
<b>Energy Analysis</b>		
Energy Class	-	"
Capacity	-	"
Rated efficiency	-	"

## Family Types

Type name: MMD-UP0031SPHY-E

Search parameters

Parameter	Value	Formula
<b>Visibility</b>		
Service Area (default)	<input type="checkbox"/>	"
Top Clearance (mm) (default)	5.0	"
Right Side Clearance (mm) (default)	450.0	"
Left Side Clearance (mm) (default)	100.0	"
Rear side (Under air intake) (default)	50.0	"
Back Clearance (mm) (default)	300.0	"
<b>Other</b>		
Sold separately parts	-	"
Refrigerant Information	R410A	"
Weight (Kg)	16	"
<b>Identity Data</b>		
Article Description	Ducted slim	"
Article Type	MMD-UP0031SPHY-E	"
Base Family Version		"
CB-NL Class		"
Content Supplier URL	www.hcltech.com	"
Copyright	©Toshiba / HCL	"@Toshiba / HCL"
EMCS	4	"4"
ETIM Article Class	EC001213	"EC001213"
Family Version		"
GLN		"
GTIN		"
Internal Art. No.		"
MEPcontent Class	HEATPUMP	"HEATPUMP"
Manufacturer	Toshiba	"Toshiba"
Manufacturer Art. No.	MMD-UP0031SPHY-E	"
Manufacturer URL	https://www.toshiba-carrier.co.jp/global/	"
Product Line	TCAC	"TCAC"
Revit Version	2017	"2017"
Stabu Code		"
Type Image		"
Keynote		"
Model	MMD-UP0031SPHY-E	"
Type Comments		"
URL	https://www.toshiba-carrier.co.jp/global/	"
Description	Ducted slim	"
Assembly Code		"
Cost		"
Watermarked By		"
Wholesaler		"
Wholesaler Art. No		"

# MMD-UP0051SPHY-E

## Family Types

Type name: MMD-UP0051SPHY-E

Search parameters

Parameter	Value	Formula
<b>Materials and Finishes</b>		
Red	Colour RGB-255 000 000	=
White	Colour RGB-255 255 255	=
<b>Electrical</b>		
MOCP (A)	15	=
MCA (A)	0.49	=
Running current-Cooling (A)	0.36/ 0.37	=
Power consumption-Cooling (Kw)	0.02	=
Running current-Heating (A)	0.36/ 0.37	=
Power consumption-Heating (Kw)	0.02	=
Frequency (Hz)	50Hz 220-240V	=
Voltage (V)	60Hz 208-230V	=
Starting current (A)	0.62/ 0.65	=
<b>Dimensions</b>		
Height (mm)	210.0	=
Width (mm)	700.0	=
Depth (mm)	450.0	=
Piping diameter (mm)-Gas	9.5	=
Piping diameter (mm)-Liquid	6.4	=
Drain pipe(mm)	VP25(OD:32mm)	=
Duct diameter (mm)	-	=
<b>Mechanical - Flow</b>		
Static pressure	10-20-30-40-50	=
Factory default	10	=
Sound pressure dB(A)-High	30	=
Sound pressure dB(A)-Mid	28	=
Sound pressure dB(A)-Low	26	=
Airflow (m3/h)-High	450	=
Airflow (m3/h)-Mid	410	=
Airflow (m3/h)-Low	380	=
<b>Mechanical - Loads</b>		
Rated Power Consumption W-High	-	=
Rated Power Consumption W-Mid	-	=
Rated Power Consumption W-Low	-	=
Seasonal & Rated efficiency	-	=
Part load	-	=
Capacities kW-Cooling	1.7	=
Capacities kW-Heating	1.9	=
<b>Energy Analysis</b>		
Energy Class	-	=
Capacity	-	=
Rated efficiency	-	=

## Family Types

Type name: MMD-UP0051SPHY-E

Search parameters

Parameter	Value	Formula
<b>Visibility</b>		
Service Area (default)	<input type="checkbox"/>	=
Top Clearance (mm) (default)	5.0	=
Right Side Clearance (mm) (default)	450.0	=
Left Side Clearance (mm) (default)	100.0	=
Rear side (Under air intake) (default)	50.0	=
Back Clearance (mm) (default)	300.0	=
<b>Other</b>		
Sold separately parts	-	=
Refrigerant information	R410A	=
Weight (Kg)	16	=
<b>Identity Data</b>		
Article Description	Ducted slim	=
Article Type	MMD-UP0051SPHY-E	=
Base Family Version	-	=
CB-NL Class	-	=
Content Supplier URL	www.hcitech.com	=
Copyright	©Toshiba / HCL	= "©Toshiba / HCL"
EMCS	4	= "4"
ETIM Article Class	EC001213	= "EC001213"
Family Version	-	=
GLN	-	=
GTIN	-	=
Internal Art. No.	-	=
MEPcontent Class	HEATPUMP	= "HEATPUMP"
Manufacturer	Toshiba	= "Toshiba"
Manufacturer Art. No.	MMD-UP0051SPHY-E	=
Manufacturer URL	https://www.toshiba-carrier.co.jp/global/	=
Product Line	TCAC	= "TCAC"
Revit Version	2017	= "2017"
Stabu Code	-	=
Type Image	-	=
Keynote	-	=
Model	MMD-UP0051SPHY-E	=
Type Comments	-	=
URL	https://www.toshiba-carrier.co.jp/global/	=
Description	Ducted slim	=
Assembly Code	-	=
Cost	-	=
Watermarked By	-	=
Wholesaler	-	=
Wholesaler Art. No	-	=

# MMD-UP0071SPHY-E

## Family Types

Type name: MMD-UP0071SPHY-E

Search parameters

Parameter	Value	Formula
<b>Materials and Finishes</b>		
Red	Colour RGB-255 000 000	=
White	Colour RGB-255 255 255	=
<b>Electrical</b>		
MOCP (A)	15	=
MCA (A)	0.49	=
Running current-Cooling (A)	0.40/ 0.42	=
Power consumption-Cooling (Kw)	0.026	=
Running current-Heating (A)	0.40/ 0.42	=
Power consumption-Heating (Kw)	0.026	=
Frequency (Hz)	50Hz 220-240V	=
Voltage (V)	60Hz 208-230V	=
Starting current (A)	0.69/ 0.73	=
<b>Dimensions</b>		
Height (mm)	210.0	=
Width (mm)	700.0	=
Depth (mm)	450.0	=
Piping diameter (mm)-Gas	9.5	=
Piping diameter (mm)-Liquid	6.4	=
Drain pipe(mm)	VP25(OD:32mm)	=
Duct diameter (mm)	-	=
<b>Mechanical - Flow</b>		
Static pressure	10-20-30-40-50	=
Factory default	10	=
Sound pressure dB(A)-High	31	=
Sound pressure dB(A)-Mid	29	=
Sound pressure dB(A)-Low	26	=
Airflow (m3/h)-High	540	=
Airflow (m3/h)-Mid	470	=
Airflow (m3/h)-Low	400	=
<b>Mechanical - Loads</b>		
Rated Power Consumption W-High	-	=
Rated Power Consumption W-Mid	-	=
Rated Power Consumption W-Low	-	=
Seasonal & Rated efficiency	-	=
Part load	-	=
Capacities kW-Cooling	2.2	=
Capacities kW-Heating	2.5	=
<b>Energy Analysis</b>		
Energy Class	-	=
Capacity	-	=
Rated efficiency	-	=

## Family Types

Type name: MMD-UP0071SPHY-E

Search parameters

Parameter	Value	Formula
<b>Visibility</b>		
Service Area (default)	<input type="checkbox"/>	=
Top Clearance (mm) (default)	5.0	=
Right Side Clearance (mm) (default)	450.0	=
Left Side Clearance (mm) (default)	100.0	=
Rear side (Under air intake) (default)	50.0	=
Back Clearance (mm) (default)	300.0	=
<b>Other</b>		
Sold separately parts	-	=
Refrigerant Information	R410A	=
Weight (Kg)	16	=
<b>Identity Data</b>		
Article Description	Ducted slim	=
Article Type	MMD-UP0071SPHY-E	=
Base Family Version		=
CB-NL Class		=
Content Supplier URL	www.hcitech.com	=
Copyright	©Toshiba / HCL	"©Toshiba / HCL"
EMCS	4	"4"
ETIM Article Class	EC001213	"EC001213"
Family Version		=
GLN		=
GTIN		=
Internal Art. No.		=
MEPcontent Class	HEATPUMP	"HEATPUMP"
Manufacturer	Toshiba	"Toshiba"
Manufacturer Art. No.	MMD-UP0071SPHY-E	=
Manufacturer URL	https://www.toshiba-carrier.co.jp/global/	=
Product Line	TCAC	"TCAC"
Revit Version	2017	"2017"
Stabu Code		=
Type Image		=
Keynote		=
Model	MMD-UP0071SPHY-E	=
Type Comments		=
URL	https://www.toshiba-carrier.co.jp/global/	=
Description	Ducted slim	=
Assembly Code		=
Cost		=
Watermarked By		=
Wholesaler		=
Wholesaler Art. No		=

# MMD-UP0091SPHY-E

## Family Types

Type name: MMD-UP0091SPHY-E

Search parameters

Parameter	Value	Formula
<b>Materials and Finishes</b>		
Red	Colour RGB-255 000 000	=
White	Colour RGB-255 255 255	=
<b>Electrical</b>		
MOCP (A)	15	=
MCA (A)	0.49	=
Running current-Cooling (A)	0.42/ 0.44	=
Power consumption-Cooling (Kw)	0.029	=
Running current-Heating (A)	0.42/ 0.44	=
Power consumption-Heating (Kw)	0.029	=
Frequency (Hz)	50Hz 220-240V	=
Voltage (V)	60Hz 208-230V	=
Starting current (A)	0.73/ 0.77	=
<b>Dimensions</b>		
Height (mm)	210.0	=
Width (mm)	700.0	=
Depth (mm)	450.0	=
Piping diameter (mm)-Gas	9.5	=
Piping diameter (mm)-Liquid	6.4	=
Drain pipe(mm)	VP25(OD:32mm)	=
Duct diameter (mm)	-	=
<b>Mechanical - Flow</b>		
Static pressure	10-20-30-40-50	=
Factory default	10	=
Sound pressure dB(A)-High	32	=
Sound pressure dB(A)-Mid	30	=
Sound pressure dB(A)-Low	26	=
Airflow (m3/h)-High	570	=
Airflow (m3/h)-Mid	500	=
Airflow (m3/h)-Low	430	=
<b>Mechanical - Loads</b>		
Rated Power Consumption W-High	-	=
Rated Power Consumption W-Mid	-	=
Rated Power Consumption W-Low	-	=
Seasonal & Rated efficiency	-	=
Part load	-	=
Capacities kW-Cooling	2.8	=
Capacities kW-Heating	3.2	=
<b>Energy Analysis</b>		
Energy Class	-	=
Capacity	-	=
Rated efficiency	-	=

## Family Types

Type name: MMD-UP0091SPHY-E

Search parameters

Parameter	Value	Formula
<b>Visibility</b>		
Service Area (default)	<input type="checkbox"/>	=
Top Clearance (mm) (default)	5.0	=
Right Side Clearance (mm) (default)	450.0	=
Left Side Clearance (mm) (default)	100.0	=
Rear side (Under air intake) (default)	50.0	=
Back Clearance (mm) (default)	300.0	=
<b>Other</b>		
Sold separately parts	-	=
Refrigerant Information	R410A	=
Weight (Kg)	16	=
<b>Identity Data</b>		
Article Description	Ducted slim	=
Article Type	MMD-UP0091SPHY-E	=
Base Family Version		=
CB-NL Class		=
Content Supplier URL	www.hcltech.com	=
Copyright	©Toshiba / HCL	= "©Toshiba / HCL"
EMCS	4	= "4"
ETIM Article Class	EC001213	= "EC001213"
Family Version		=
GLN		=
GTIN		=
Internal Art. No.		=
MEPcontent Class	HEATPUMP	= "HEATPUMP"
Manufacturer	Toshiba	= "Toshiba"
Manufacturer Art. No.	MMD-UP0091SPHY-E	=
Manufacturer URL	https://www.toshiba-carrier.co.jp/global/	=
Product Line	TCAC	= "TCAC"
Revit Version	2017	= "2017"
Stabu Code		=
Type Image		=
Keynote		=
Model	MMD-UP0091SPHY-E	=
Type Comments		=
URL	https://www.toshiba-carrier.co.jp/global/	=
Description	Ducted slim	=
Assembly Code		=
Cost		=
Watermarked By		=
Wholesaler		=
Wholesaler Art. No		=

# MMD-UP0121SPHY-E

## Family Types

Type name: MMD-UP0121SPHY-E

Search parameters

Parameter	Value	Formula
<b>Materials and Finishes</b>		
Red	Colour RGB-255 000 000	"
White	Colour RGB-255 255 255	"
<b>Electrical</b>		
MOCP (A)	15	"
MCA (A)	0.55	"
Running current-Cooling (A)	0.44/ 0.46	"
Power consumption-Cooling (Kw)	0.031	"
Running current-Heating (A)	0.44/ 0.46	"
Power consumption-Heating (Kw)	0.031	"
Frequency (Hz)	50Hz 220-240V	"
Voltage (V)	60Hz 208-230V	"
Starting current (A)	0.77/ 0.81	"
<b>Dimensions</b>		
Height (mm)	210.0	"
Width (mm)	700.0	"
Depth (mm)	450.0	"
Piping diameter (mm)-Gas	9.5	"
Piping diameter (mm)-Liquid	6.4	"
Drain pipe(mm)	VP25(OD:32mm)	"
Duct diameter (mm)	-	"
<b>Mechanical - Flow</b>		
Static pressure	10-20-30-40-50	"
Factory default	10	"
Sound pressure dB(A)-High	33	"
Sound pressure dB(A)-Mid	30	"
Sound pressure dB(A)-Low	27	"
Airflow (m3/h)-High	600	"
Airflow (m3/h)-Mid	520	"
Airflow (m3/h)-Low	440	"
<b>Mechanical - Loads</b>		
Rated Power Consumption W-High	-	"
Rated Power Consumption W-Mid	-	"
Rated Power Consumption W-Low	-	"
Seasonal & Rated efficiency	-	"
Part load	-	"
Capacities kW-Cooling	3.6	"
Capacities kW-Heating	4	"
<b>Energy Analysis</b>		
Energy Class	-	"
Capacity	-	"
Rated efficiency	-	"

## Family Types

Type name: MMD-UP0121SPHY-E

Search parameters

Parameter	Value	Formula
<b>Visibility</b>		
Service Area (default)	<input type="checkbox"/>	"
Top Clearance (mm) (default)	5.0	"
Right Side Clearance (mm) (default)	450.0	"
Left Side Clearance (mm) (default)	100.0	"
Rear side (Under air intake) (default)	50.0	"
Back Clearance (mm) (default)	300.0	"
<b>Other</b>		
Sold separately parts	-	"
Refrigerant Information	R410A	"
Weight (Kg)	16	"
<b>Identity Data</b>		
Article Description	Ducted slim	"
Article Type	MMD-UP0121SPHY-E	"
Base Family Version		"
CB-NL Class		"
Content Supplier URL	www.hcltech.com	"
Copyright	©Toshiba / HCL	"©Toshiba / HCL"
EMCS	4	"4"
ETIM Article Class	EC001213	"EC001213"
Family Version		"
GLN		"
GTIN		"
Internal Art. No.		"
MEPcontent Class	HEATPUMP	"HEATPUMP"
Manufacturer	Toshiba	"Toshiba"
Manufacturer Art. No.	MMD-UP0121SPHY-E	"
Manufacturer URL	https://www.toshiba-carrier.co.jp/global/	"
Product Line	TCAC	"TCAC"
Revit Version	2017	"2017"
Stabu Code		"
Type Image		"
Keynote		"
Model	MMD-UP0121SPHY-E	"
Type Comments		"
URL	https://www.toshiba-carrier.co.jp/global/	"
Description	Ducted slim	"
Assembly Code		"
Cost		"
Watermarked By		"
Wholesaler		"
Wholesaler Art. No		"



**Thank You**