

Antena Flashd C48 (HDTF-C48V) Ref. 1818 ; (HDTF-C48G) Ref. 1816  
 Antena Flashd C58 (HDTF-C58V) Ref. 1819  
 Antena Flashd C60 (HDTF-C60V) Ref. 1821 ; (HDTF-C60G) Ref. 1820  
 Antena Flashd C69 (HDTF-C69V) Ref. 1817

V = Verde / Vert / Green  
 G = Gris / Grise / Gray  
 C = Canal / Channel

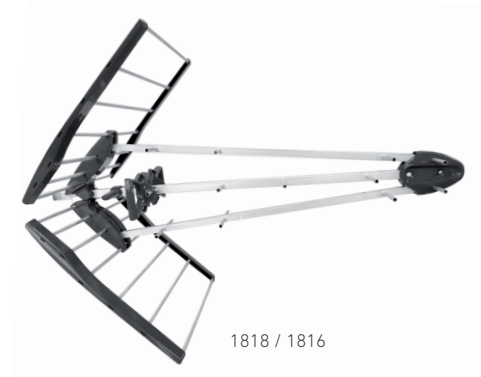

1818 / 1816

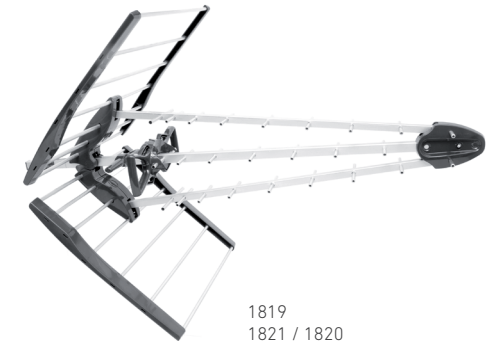

1819  
 1821 / 1820

### Características Técnicas / Données Techniques / Technical Data

— Modelos / Modèles / Models :

- Flashd C48 (HDTF-C48V) ▶ 21-48 (470-694 MHz)
- Flashd C58 (HDTF-C58V) ▶ 21-58 (470-774 MHz)
- Flashd C60 (HDTF-C60V) ▶ 21-60 (470-790 MHz)
- Flashd C69 (HDTF-C69V) ▶ 21-69 (470-862 MHz)

— Relación D/A / Rapport AV/AR / Front-to-Back ratio :  $\geq 20$  dB

- Ángulo de apertura / Angle d'ouverture / Beamwidth :
- 470 MHz [55° (H) ; 65° (V)]
  - 670 MHz [40° (H) ; 50° (V)]
  - 860 MHz [25° (H) ; 30° (V)] (HDTF-C69V model)

— Carga del viento / Charge au vent / Windload : 105 N (130 km/h) , 150 N (150 km/h)

— Ganancia / Gain :

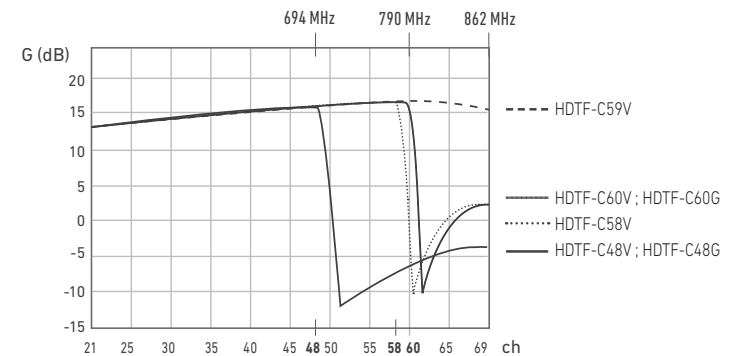

1. Preparación de la antena / Préparation de l'antenne / Preparing the antenna

1.1. DESPLIEGUE  
OUVERTURE  
UNFOLDING

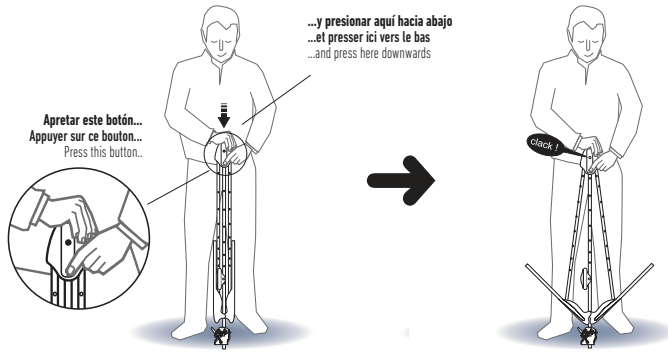

1.2. POSICIÓN DEL DIPOLO  
POSITION DU DIPÔLE  
DIPOLE POSITION

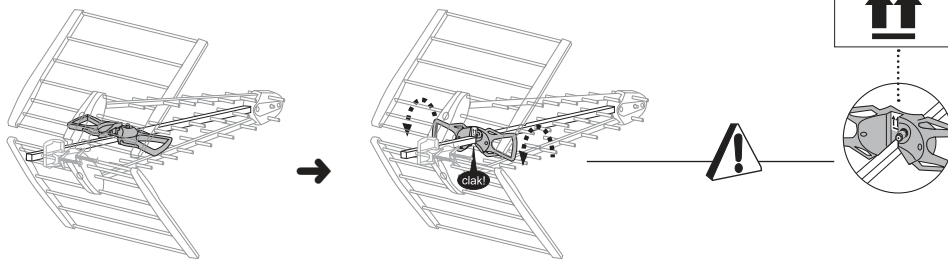

3. Ajuste de polaridad / Ajustement de polarité / Polarity adjustment

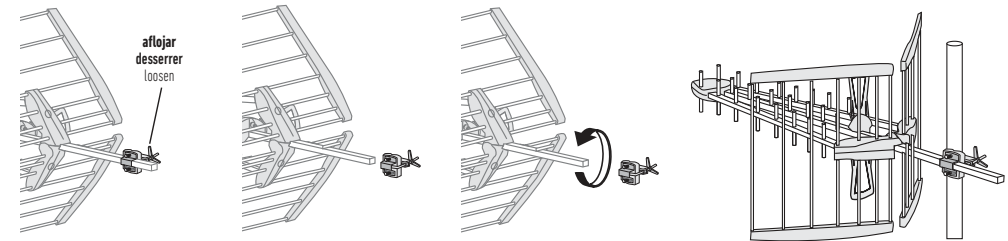

**Accesorios suministrados**  
Accessoires fournis  
Accessories supplied

-  **Conector F roscable**  
Connecteur F à visser  
Screw-on F plug
-  **Capuchón protector**  
Capuchon protecteur  
Protection cap

2. Conexión del cable coaxial / Raccordement du câble coaxial / Connecting the coaxial cable

